

**LPDR Series**  
**Low Pressure Drop Heat Sink**  
**with Mounting Tabs**

**ALPHA**

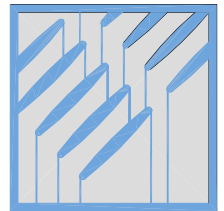

### DIM

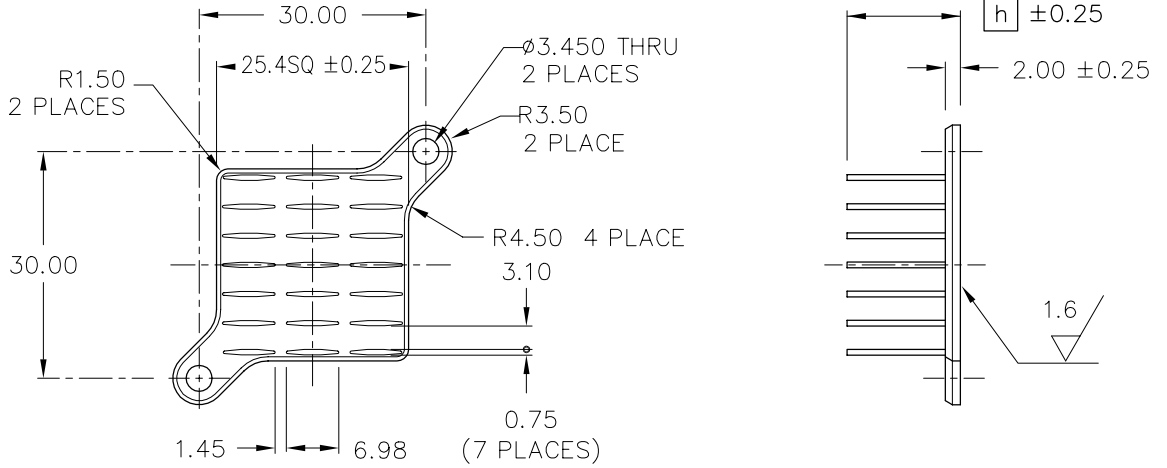

MODEL	HEIGHT $h$	WEIGHT (grams)
LPDR25-10B	10	5.8
LPDR25-15B	15	7.0
LPDR25-20B	20	8.2

MATERIAL : A 6063  
 FINISH : BLACK ANODIZE  
 DIMENSIONS : mm

### DATA

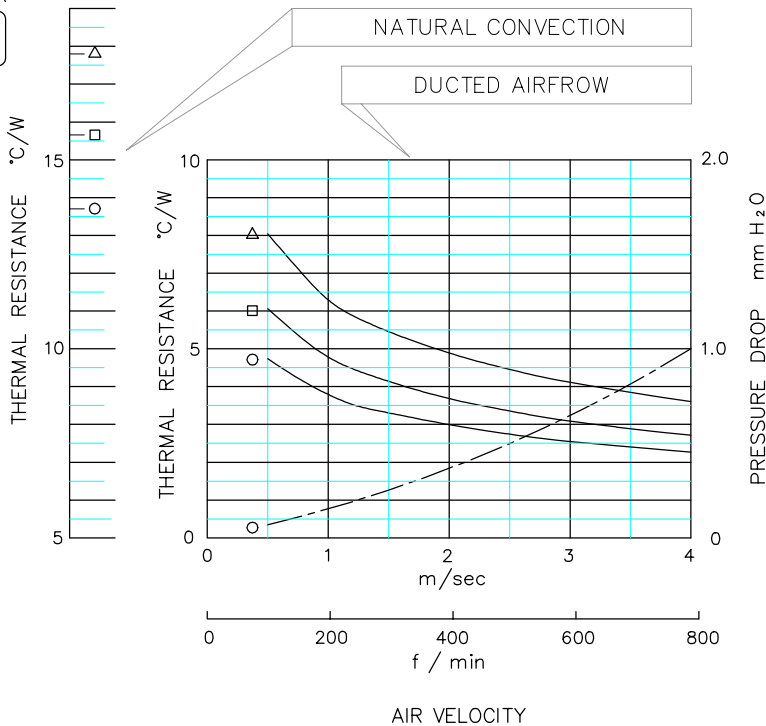

△ LPDR25-10B  
 □ LPDR25-15B  
 ○ LPDR25-20B

● Thermal Resistance ( Ducted )  
 ( Solid Line ——— )  
 ● Pressure Drop  
 ( Center Line - - - )

■ Based on Alpha's Standard Test Procedure. (Refer to page marked Technical Information.)  
 Dummy Heater Size : 12.7SQ

■ Natural Convection Tests  
 Dissipated Power: 3.15(W)

# ALPHA

Low Pressure Drop Heat Sink  
with Mounting Tabs

# LPDR 30

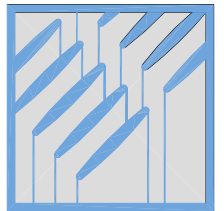

DIM

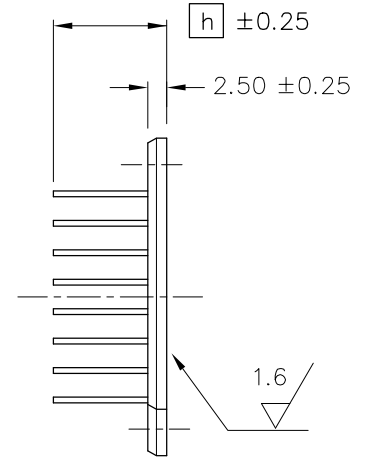
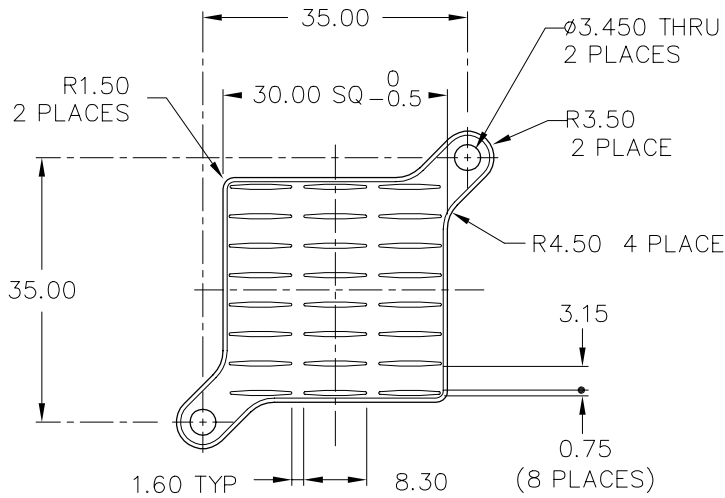

MODEL	HEIGHT [h]	WEIGHT (grams)
LPDR30-10B	10	8.9
LPDR30-15B	15	10.5
LPDR30-20B	20	12.1

MATERIAL : A 6063  
FINISH : BLACK ANODIZE  
DIMENSIONS : mm

DATA

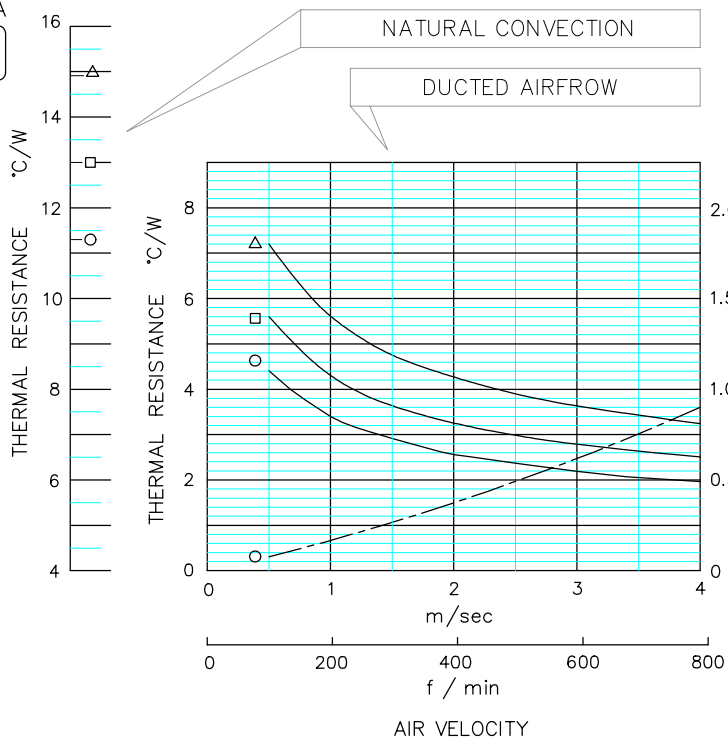

Alpha Company Ltd.

256-1 UEDA, NUMAZU-CITY SHIZUOKA-PREF., JAPAN  
PHONE +81(55)966 0789  
FAX +81(55)966 9192  
E mail : alpha@micforg.co.jp  
URL : http://www.micforg.co.jp

Alpha Novatech, Inc. - a subsidiary of Alpha Company.

473 Sapena Ct. #12 Santa Clara, CA 95054 USA  
PHONE +1(408)567-8082  
FAX +1(408)567-8053  
E mail : sales@alphanovatech.com  
URL : http://www.alphanovatech.com

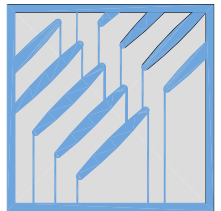

### DIM

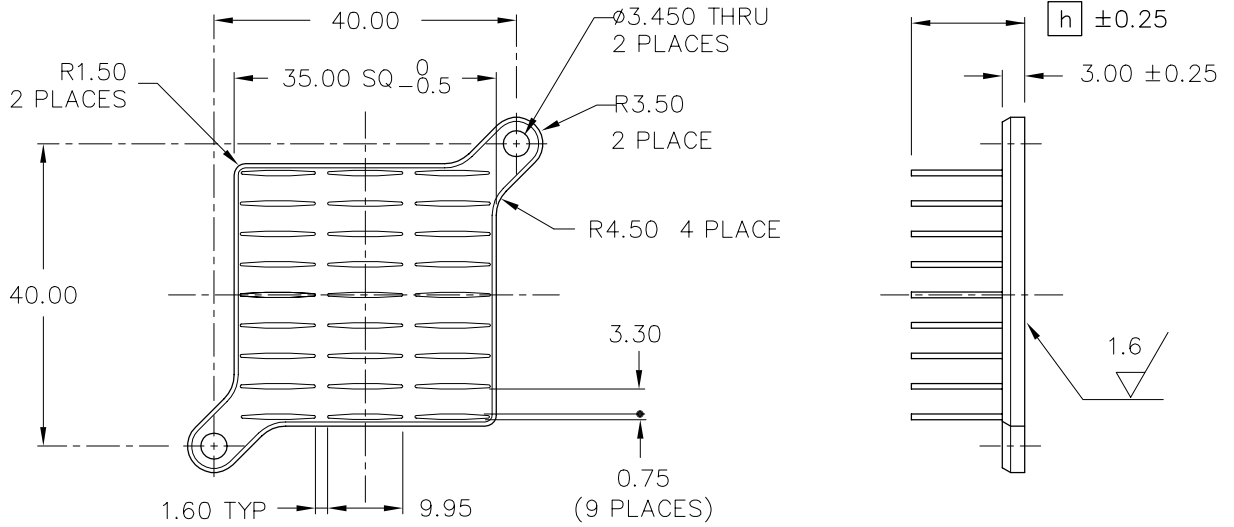

MODEL	HEIGHT [h]	WEIGHT (grams)
LPDR35-10B	10	13.5
LPDR35-15B	15	15.7
LPDR35-20B	20	17.9

MATERIAL : A 6063  
 FINISH : BLACK ANODIZE  
 DIMENSIONS : mm

### DATA

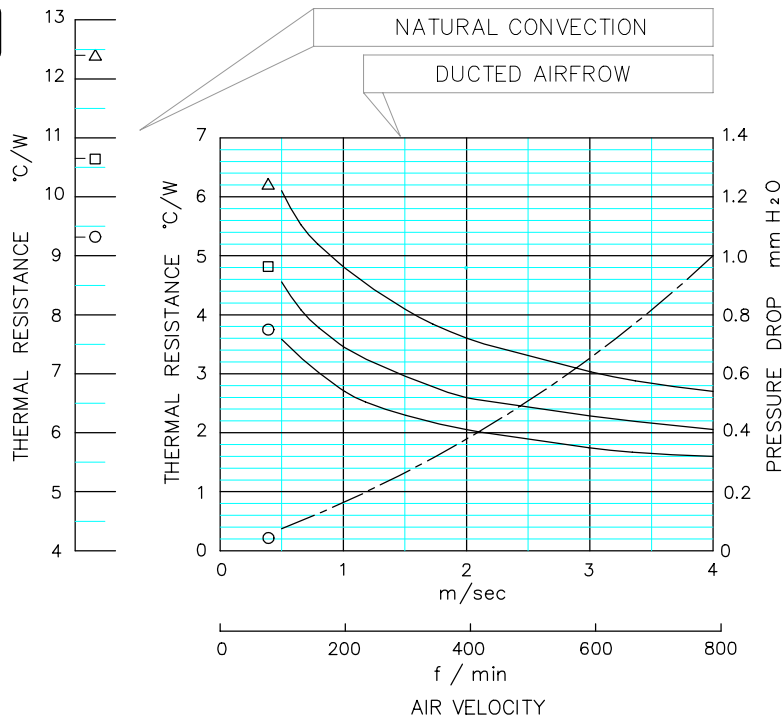

REF



### BOARD KEEPOUT PATTERNS FOR LPDR25, UBR25 AND NR25

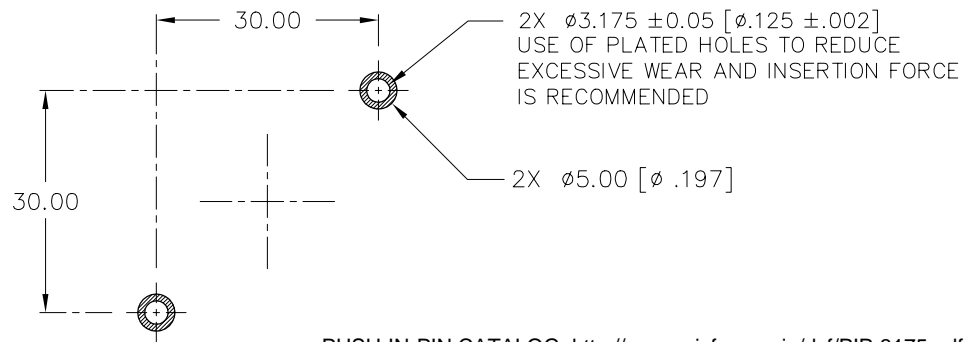

PUSH-IN-PIN CATALOG: <http://www.micforg.co.jp/dxf/PIP-3175.pdf>

### BOARD KEEPOUT PATTERNS FOR LPDR30, UBR30 AND NR30

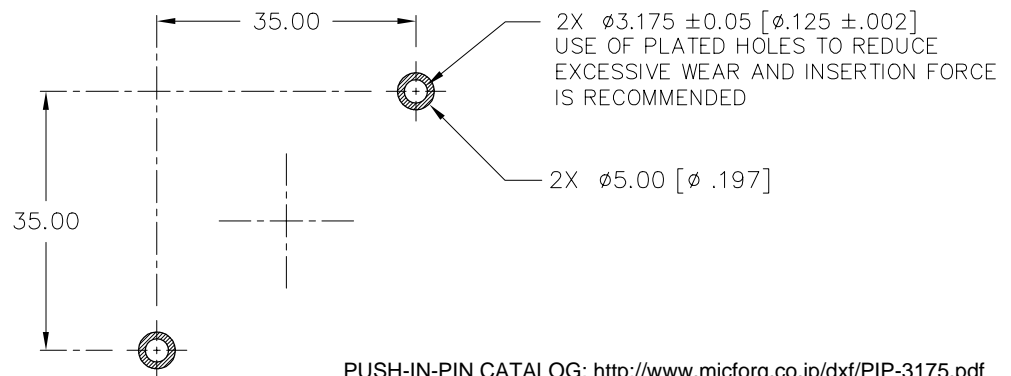

PUSH-IN-PIN CATALOG: <http://www.micforg.co.jp/dxf/PIP-3175.pdf>

### BOARD KEEPOUT PATTERNS FOR LPDR35, UBR35 AND NR35

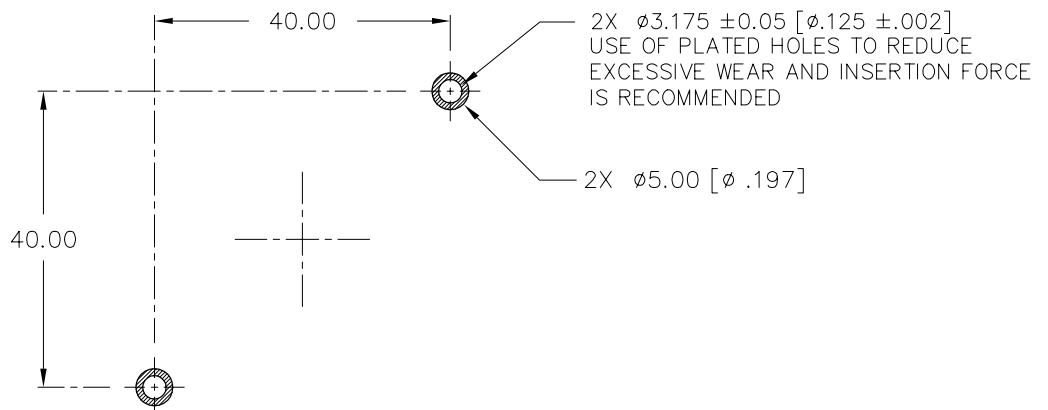

PUSH-IN-PIN CATALOG: <http://www.micforg.co.jp/dxf/PIP-3175.pdf>