

REVISIONS				
REV	DATE	DESCRIPTION	CHG	APPR

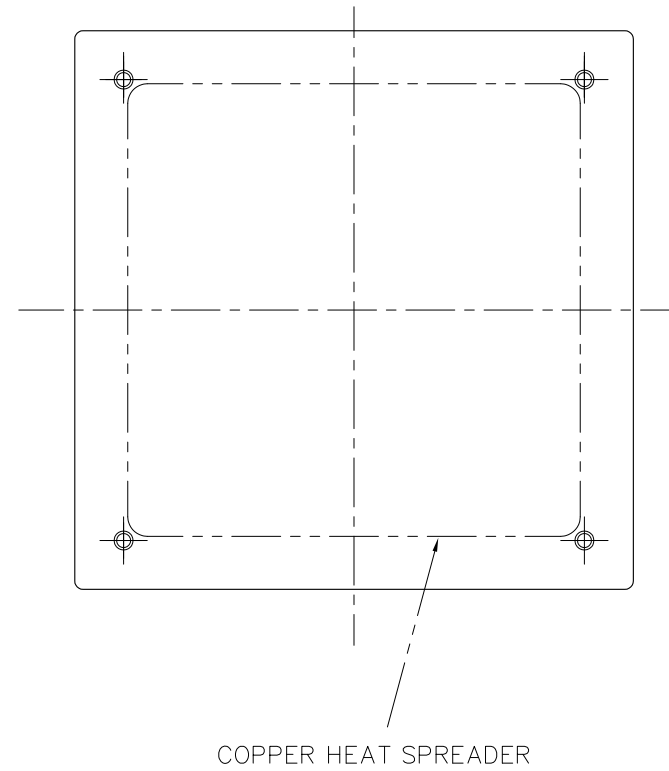
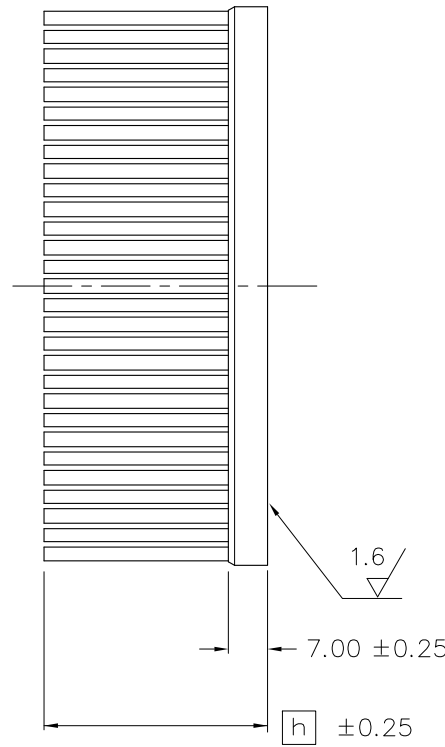
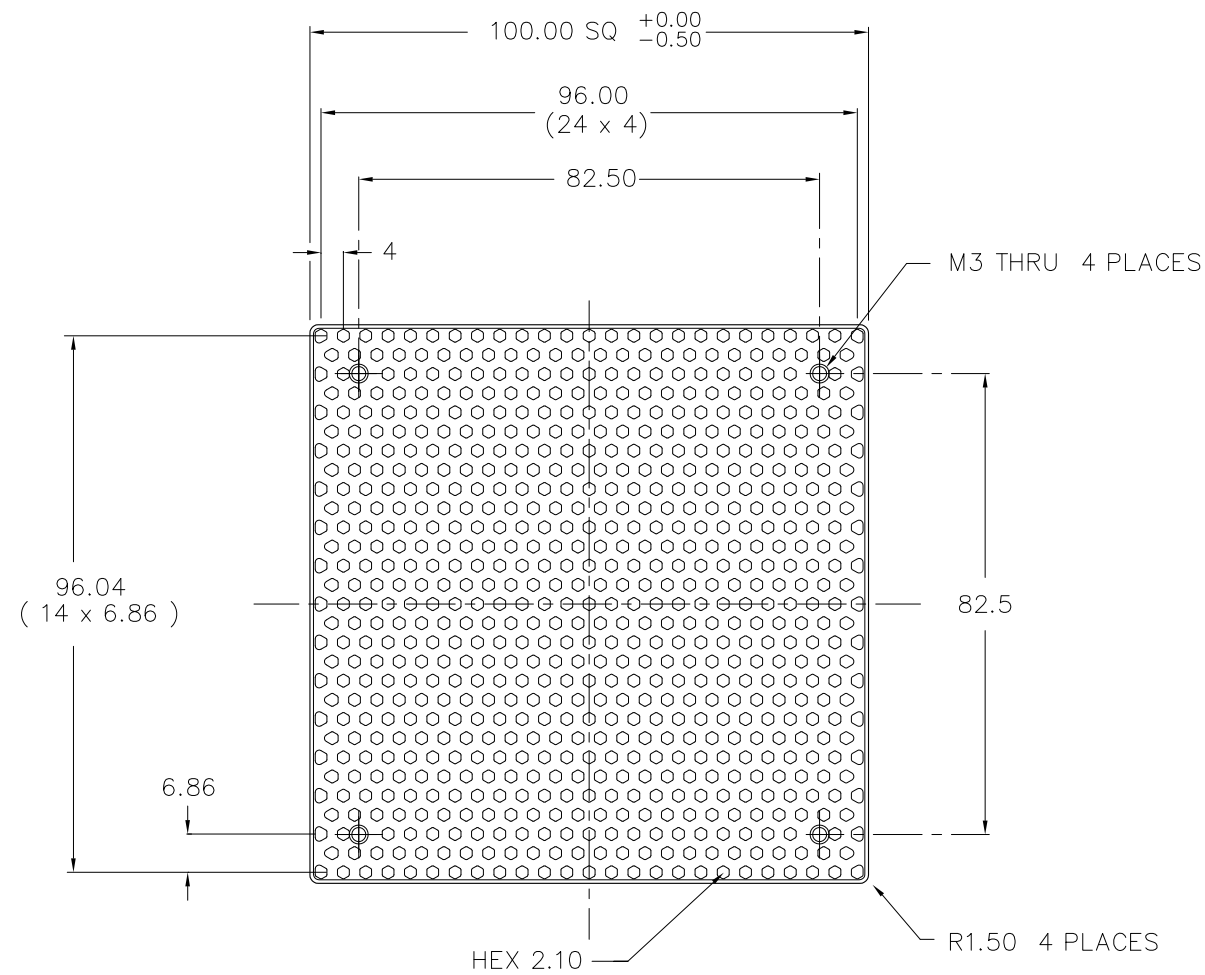

- NOTES : UNLESS OTHERWISE SPECIFIED
1. INTERPRET DIMENSIONS AND TOLERANCES PER ANSI Y14.5M
  2. ALL DIMENSIONS ARE IN MILLIMETERS.
  3. MATERIAL  
HEATSINK: ALUMINUM 6063  
HEAT SPREADER: C1100 COPPER or 1020 COPPER
  4. FINISH  
HAETSINK: BLACK ANODIZE  
(EXCEPT BASE SURFACE AND THREADS)
  5. TOLERANCES : .XX ±0.254  
.XXX ±0.127  
ANGLES ± 1°
  6. REMOVE ALL BURRS AND BREAK SHARP EDGES.  
UNSPECIFIED CORNER R0.5 MAX OR C0.5 MAX.
  7. A BEND OF THE FIN: THE FINS MUST NOT CONTACT.
  8. MARK " MODEL # , ALPHA CO.,LTD " IN FIN SURFACE OR BASE SIDE.
  9. NO OIL ON THE BASE. OXIDIZATION OR DISCOLORATION IS ACCEPTABLE UNLESS IF THE SURFACE ROUGHNESS IS SIGNIFICANTLY AFFECTED.

40.00	FHC10040B	S001 YT 0E	
25.00	FHC10025B	S001 YT 0D	
<b>h</b> HEIGHT	MODEL NO.	PART NO.	REMARK

<b>ALPHA CO.,LTD.</b>		CSTM'R'S PART NO.	
	MATERIAL SEE NOTE 3. 4	NAME FHC100XXB	
SCALE 1 : 1	APPR & CHCK Y.SUZUKI	DWG NO. S001YTOC	REV
DATE APR 17 2014	DSGN & DWG Y. SUZUKI	RDCTN:	LOFF: