

UBM_S Series UBH_S Series

Low Pressure Drop and
Low Thermal Resistance Heat Sink
with Attachment Holes

ALPHA

ALPHA

Low Pressure Drop and
Low Thermal Resistance Heat Sink
with attachment holes

UBM60S

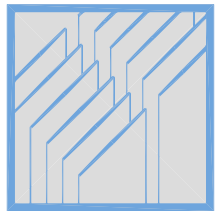

DIM

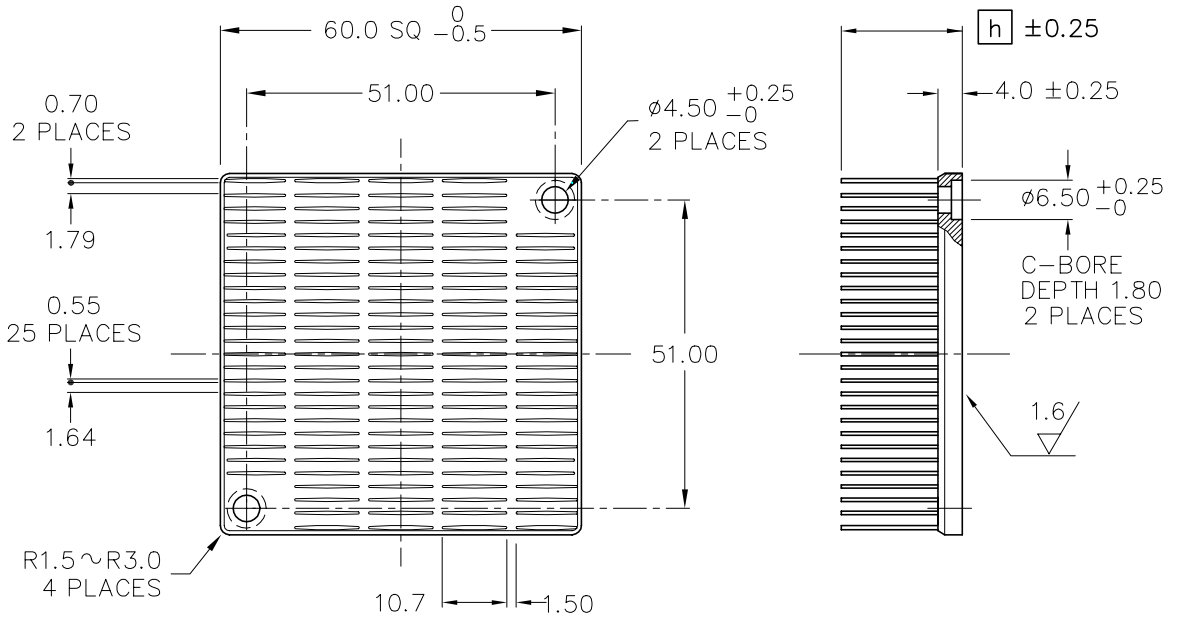

MODEL	HEIGHT [h]	WEIGHT (grams)
UBM60S-15B	15	56.8
UBM60S-20B	20	64.8
UBM60S-25B	25	72.8

MATERIAL : A 6063
FINISH : BLACK ANODIZE
DIMENSIONS : mm

DATA

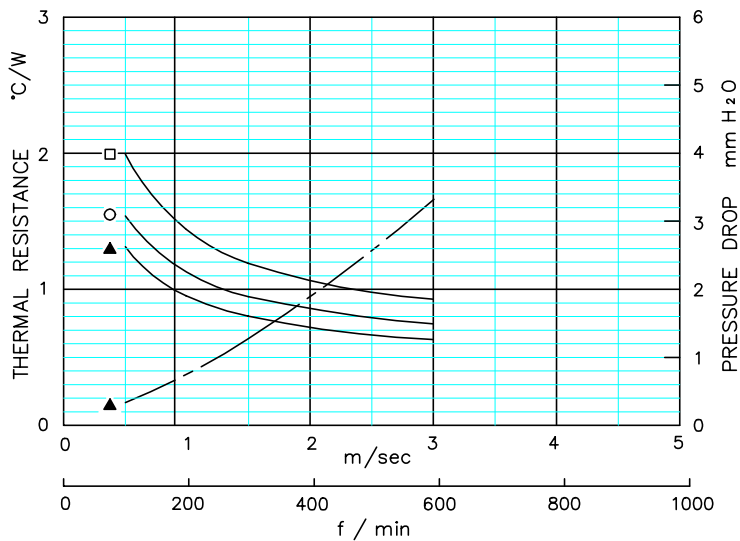

□ UBM60S-15B
○ UBM60S-20B
▲ UBM60S-25B

● DUCTED CONDITION
DUMMY HEATER SIZE: 12.7 SQ
THERMAL RESISTANCE _____
PRESURE DROP - - - - -

AIR VELOCITY: DUCTED CONDITION

■ BASED ON ALPHA'S STANDARD TEST PROCEDURE. REFER TO TECHNICAL INFORMATION.

Alpha Company Ltd.

256-1 UEDA, NUMAZU-CITY SHIZUOKA-PREF., JAPAN
PHONE +81(55)966 0789
FAX +81(55)966 9192
E mail : alpha@micforg.co.jp
URL : <http://www.micforg.co.jp>

Alpha Novatech, Inc. - a subsidiary of Alpha Company.

473 Sapena Ct. #12 Santa Clara, CA 95054 USA
PHONE +1(408)567-8082
FAX +1(408)567-8053
E mail : sales@alphanovatech.com
URL : <http://www.alphanovatech.com>

ALPHA

Low Pressure Drop and
Low Thermal Resistance Heat Sink
with attachment holes

UBM70S

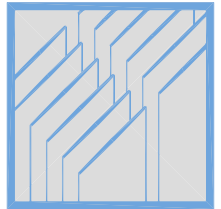

DIM

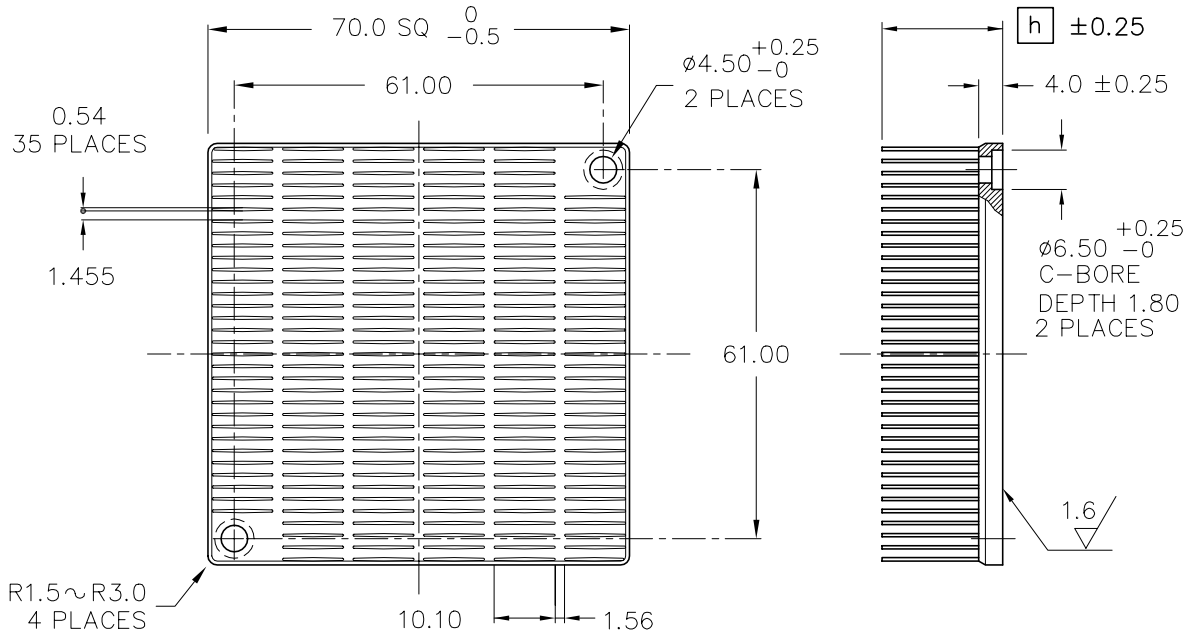

MODEL	HEIGHT [h]	WEIGHT (grams)
UBM70S-15B	15	97.0
UBM70S-20B	20	108.7
UBM70S-25B	25	120.4

MATERIAL : A 6063
FINISH : BLACK ANODIZE
DIMENSIONS : mm

DATA

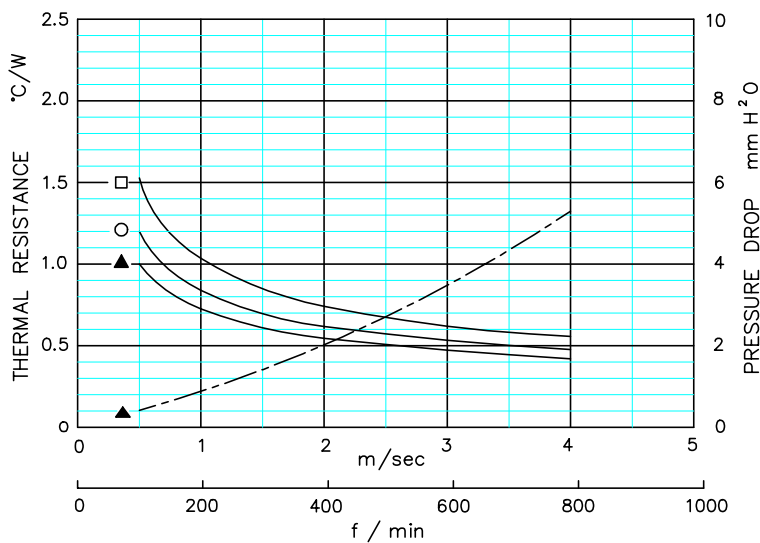

□ UBM70S-15B
○ UBM70S-20B
▲ UBM70S-25B

● DUCTED CONDITION
DUMMY HEATER SIZE: 12.7 SQ
THERMAL RESISTANCE ———
PRESSURE DROP - - - - -

AIR VELOCITY: DUCTED CONDITION

■ BASED ON ALPHA'S STANDARD TEST PROCEDURE. REFER TO TECHNICAL INFORMATION.

Alpha Company Ltd.

256-1 UEDA, NUMAZU-CITY SHIZUOKA-PREF., JAPAN
PHONE +81(55)966 0789
FAX +81(55)966 9192
E mail : alpha@micforg.co.jp
URL : <http://www.micforg.co.jp>

Alpha Novatech, Inc. - a subsidiary of Alpha Company.

473 Sapena Ct. #12 Santa Clara, CA 95054 USA
PHONE +1(408)567-8082
FAX +1(408)567-8053
E mail : sales@alphanovatech.com
URL : <http://www.alphanovatech.com>

REF



● BOARD KEEPOUT PATTERNS

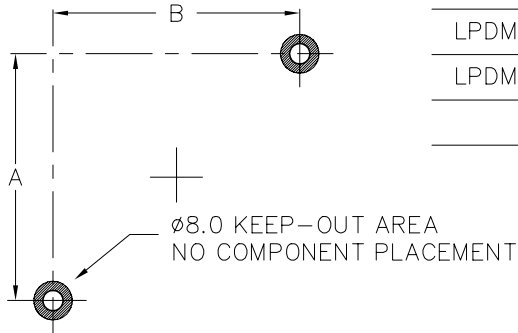

LPDM60S AND UBM60S	51.0	51.0
LPDM70S AND UBM70S	61.0	61.0
MODEL	A	B

● INSTALLATION

USE HEX NUTS M3x0.5

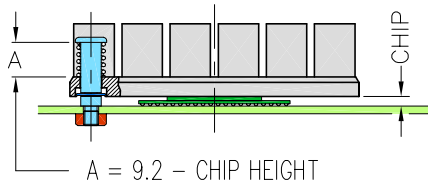

REQUIRES $\phi 3.2$ THRU HOLES IN BOARD.
RECOMMENDED P.C.B THICKNESS 1.6mm.
MINIMUM CHIP HEIGHT 1.5mm.

USE PEM KF2-M3 OR KFS2-M3 NUTS

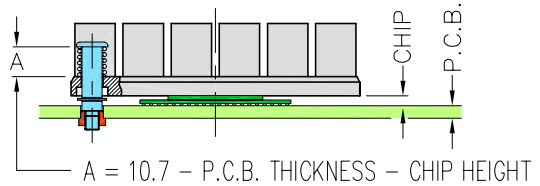

REQUIRES $\phi 4.22 +0.08/-0$ THRU HOLES IN BOARD.
PEM-NUTS SHOULD BE PRE-APPLIED INTO P.C.B
RECOMMENDED P.C.B THICKNESS 1.6~2.6mm.

USE CUSTOM BACKING-PLATE

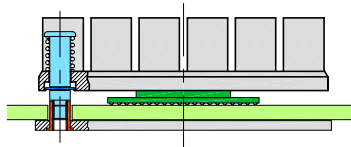

CUSTOM DESIGN FOR ANY P.C.B THICKNESS.

SOULDER-SCREW/RETAINING RING E-2.5

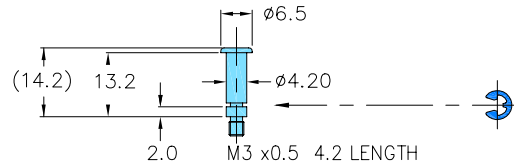

REFER TO THE DRAWING FOR DETAIL SPECIFICATION.

● FORCE

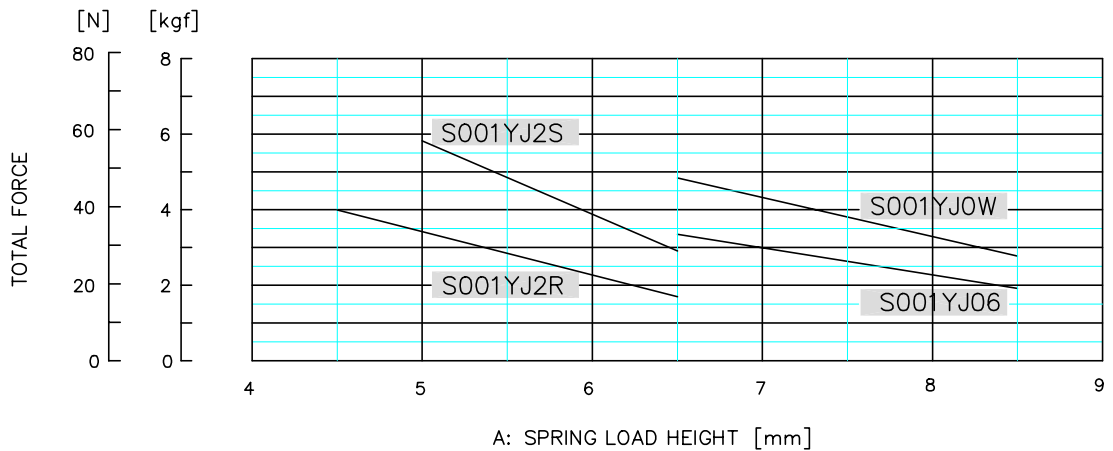

ALPHA

Low Pressure Drop and
Low Thermal Resistance Heat Sink
with attachment holes

UBH60S

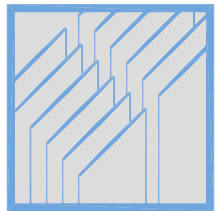

DIM

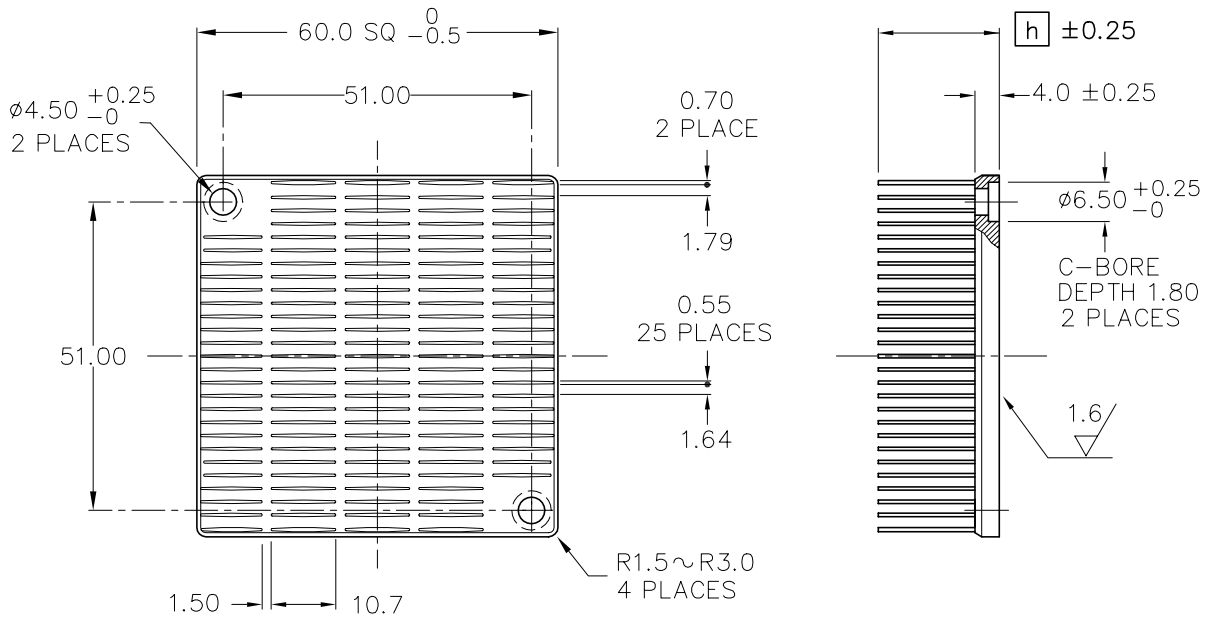

MODEL	HEIGHT [h]	WEIGHT (grams)
UBH60S-15B	15	56.8
UBH60S-20B	20	64.8
UBH60S-25B	25	72.8

MATERIAL : A 6063
FINISH : BLACK ANODIZE
DIMENSIONS : mm

DATA

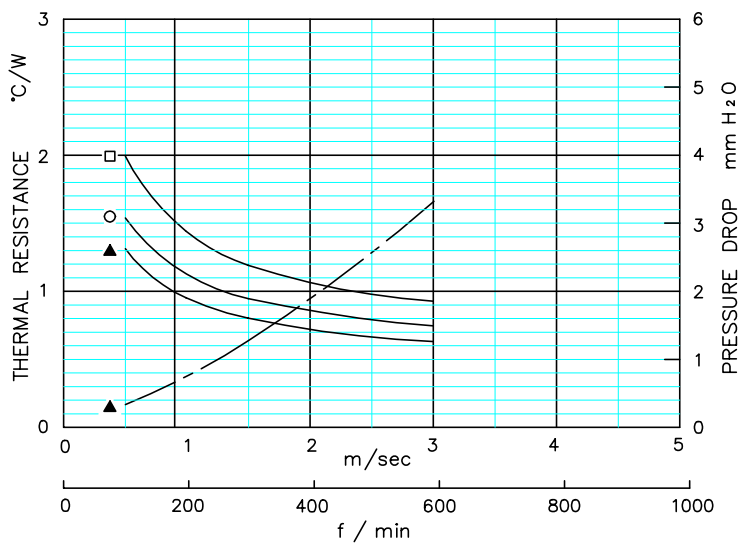

□ UBH60S-15B
○ UBH60S-20B
▲ UBH60S-25B

● DUCTED CONDITION
DUMMY HEATER SIZE: 12.7 SQ
THERMAL RESISTANCE _____
PRESSURE DROP - - - - -

AIR VELOCITY: DUCTED CONDITION

■ BASED ON ALPHA'S STANDARD TEST PROCEDURE.
REFER TO TECHNICAL INFORMATION.

Alpha Company Ltd.

256-1 UEDA, NUMAZU-CITY SHIZUOKA-PREF., JAPAN
PHONE +81(55)966 0789
FAX +81(55)966 9192
E mail : alpha@micforg.co.jp
URL : <http://www.micforg.co.jp>

Alpha Novatech, Inc. - a subsidiary of Alpha Company.

473 Sapena Ct. #12 Santa Clara, CA 95054 USA
PHONE +1(408)567-8082
FAX +1(408)567-8053
E mail : sales@alphanovatech.com
URL : <http://www.alphanovatech.com>

ALPHA

Low Pressure Drop and
Low Thermal Resistance Heat Sink
with attachment holes

UBH70S

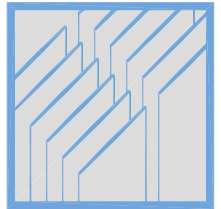

DIM

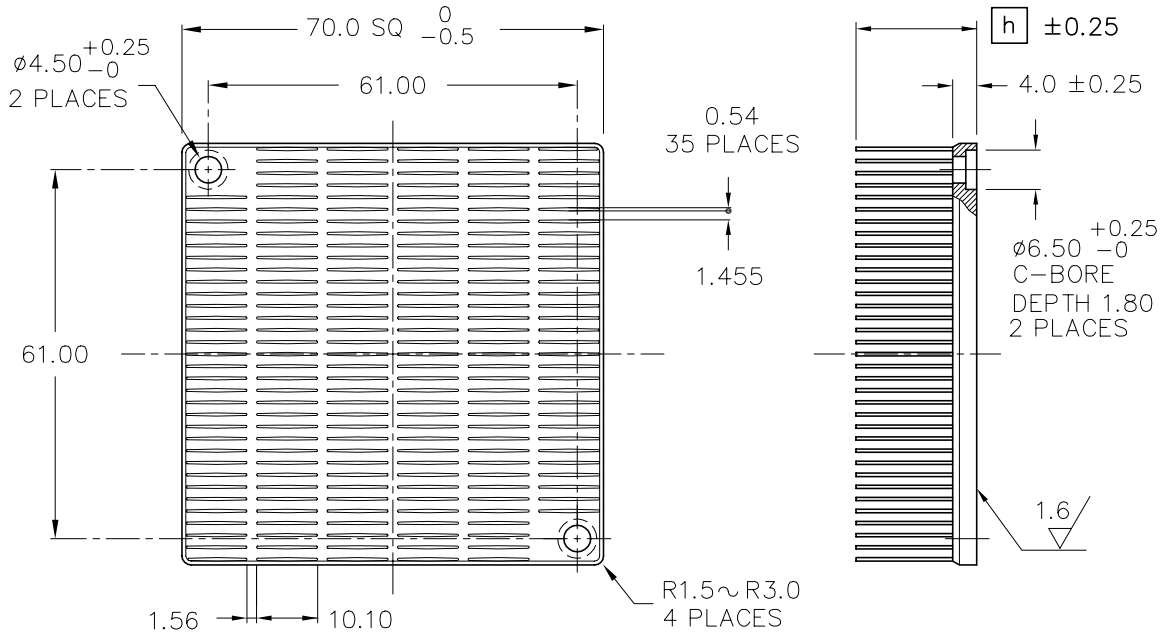

MODEL	HEIGHT [h]	WEIGHT (grams)
UBH70S-15B	15	97.0
UBH70S-20B	20	108.7
UBH70S-25B	25	120.4

MATERIAL : A 6063
FINISH : BLACK ANODIZE
DIMENSIONS : mm

DATA

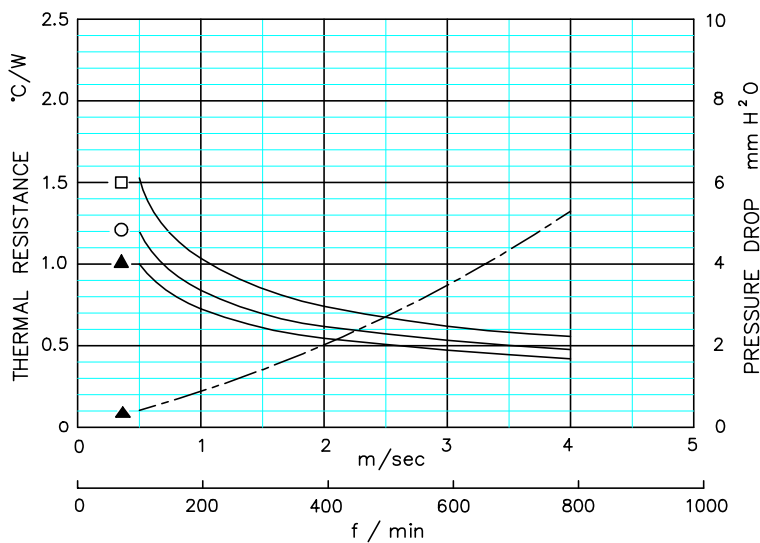

□ UBH70S-15B
○ UBH70S-20B
▲ UBH70S-25B

● DUCTED CONDITION
DUMMY HEATER SIZE: 12.7 SQ
THERMAL RESISTANCE ———
PRESSURE DROP - - -

■ BASED ON ALPHA'S STANDARD TEST PROCEDURE.
REFER TO TECHNICAL INFORMATION.

Alpha Company Ltd.

256-1 UEDA, NUMAZU-CITY SHIZUOKA-PREF., JAPAN
PHONE +81(55)966 0789
FAX +81(55)966 9192
E mail : alpha@micforg.co.jp
URL : <http://www.micforg.co.jp>

Alpha Novatech, Inc. - a subsidiary of Alpha Company.

473 Sapena Ct. #12 Santa Clara, CA 95054 USA
PHONE +1(408)567-8082
FAX +1(408)567-8053
E mail : sales@alphanovatech.com
URL : <http://www.alphanovatech.com>

REF



● BOARD KEEPOUT PATTERNS

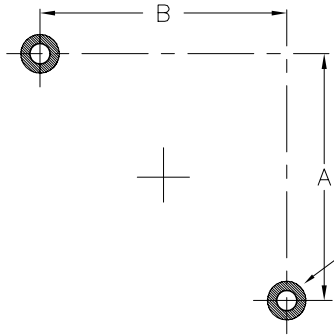

∅8.0 KEEP-OUT AREA
NO COMPONENT PLACEMENT

LPDH60S AND UBH60S	51.0	51.0
LPDH70S AND UBH70S	61.0	61.0
MODEL	A	B

● INSTALLATION

USE HEX NUTS M3x0.5

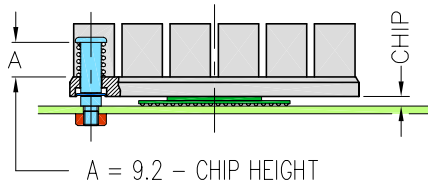

$A = 9.2 - \text{CHIP HEIGHT}$

REQUIRES ∅3.2 THRU HOLES IN BOARD.
RECOMMENDED P.C.B THICKNESS 1.6mm.
MINIMUM CHIP HEIGHT 1.5mm.

USE PEM KF2-M3 OR KFS2-M3 NUTS

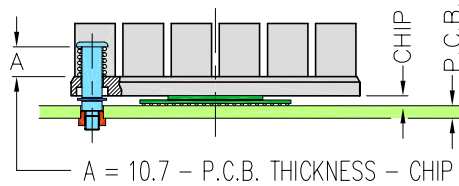

$A = 10.7 - \text{P.C.B. THICKNESS} - \text{CHIP HEIGHT}$

REQUIRES ∅4.22 +0.08/-0 THRU HOLES IN BOARD.
PEM-NUTS SHOULD BE PRE-APPLIED INTO P.C.B
RECOMMENDED P.C.B THICKNESS 1.6~2.6mm.

USE CUSTOM BACKING-PLATE

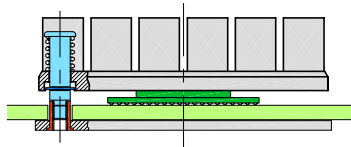

CUSTOM DESIGN FOR ANY P.C.B THICKNESS.

SOULDER-SCREW/RETAINING RING E-2.5

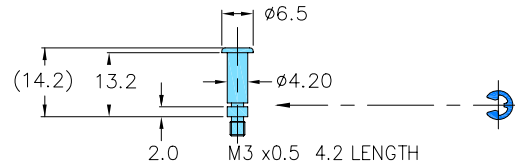

REFER TO THE DRAWING FOR DETAIL SPECIFICATION.

● FORCE



A: SPRING LOAD HEIGHT [mm]