

T Series

Thin fin and Low profile Heat Sink

ALPHA

ALPHA

Thin fin and Low profile Heat Sink

T19

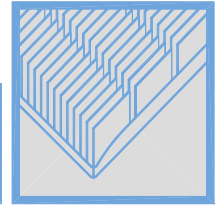

DIM

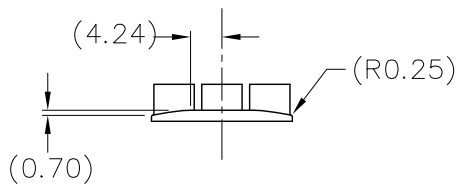
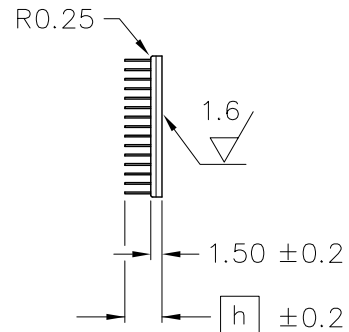
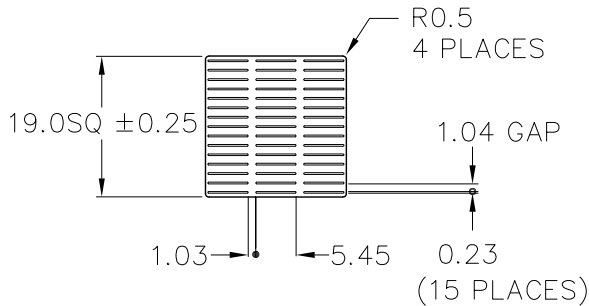

HEAT SINK
 MATERIAL : A 6063
 FINISH : BLACK ANODIZE

MODEL	HEIGHT h	WEIGHT (grams)
T19-3B	3.0	1.6
T19-4B	4.0	1.7
T19-5B	5.0	1.8
T19-6B	6.0	1.9

Dimensions : mm

DATA

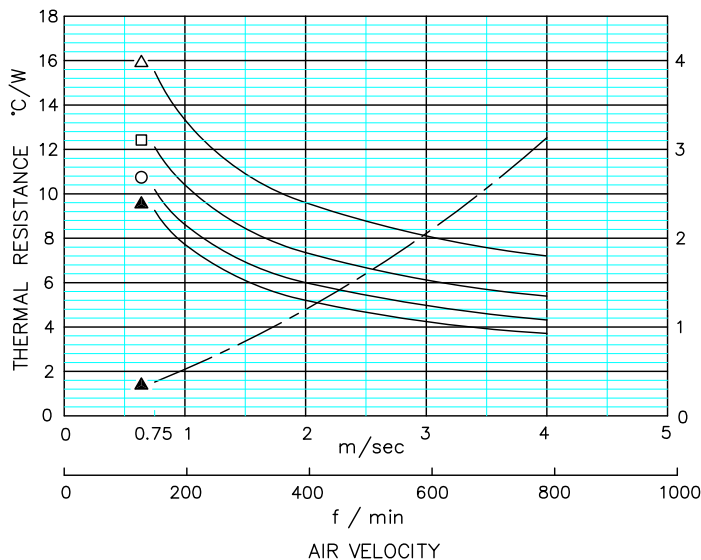

- Thermal Resistance (Ducted)
 (Solid Line —)
- Pressure Drop
 (Center Line - - -)

- △ T19-3B
- T19-4B
- T19-5B
- ▲ T19-6B

■ Based on Alpha's Standard Test Procedure. (Refer to page marked Technical Information.)
 Dummy Heater Size : □ 12.7(mm)

Alpha Company Ltd.

256-1 UEDA, NUMAZU-CITY SHIZUOKA-PREF., JAPAN
 PHONE +81(55)966 0789
 FAX +81(55)966 9192
 E mail : alpha@micforg.co.jp
 URL : http://www.micforg.co.jp

Alpha Novatech, Inc. - a subsidiary of Alpha Company.

473 Sapena Ct. #12 Santa Clara, CA 95054 USA
 PHONE +1(408)567-8082
 FAX +1(408)567-8053
 E mail : sales@alphanovatech.com
 URL : http://www.alphanovatech.com

ALPHA

Thin fin and Low profile Heat Sink

T25

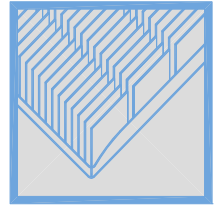

DIM

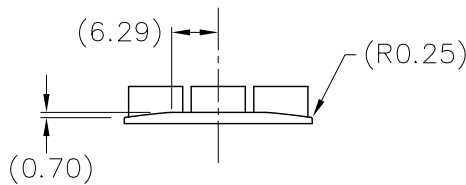
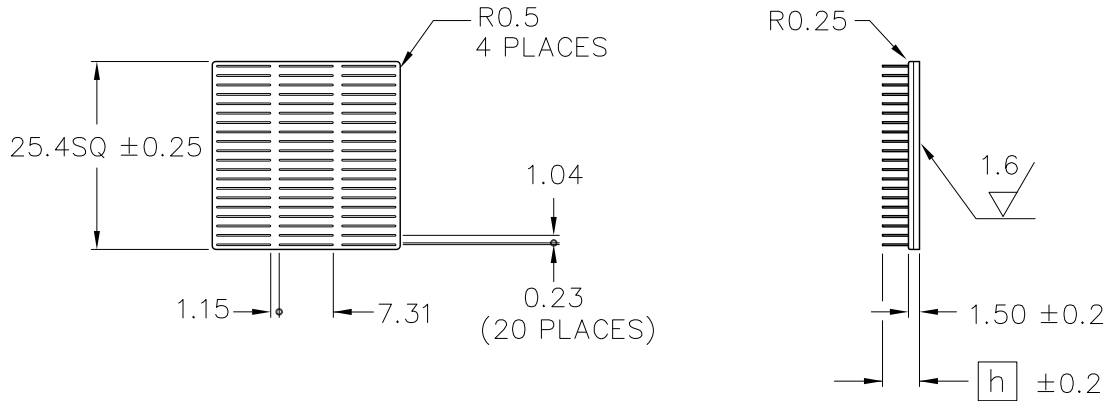

MODEL	HEIGHT h	WEIGHT (grams)
T25-3B	3.0	2.8
T25-4B	4.0	3.0
T25-5B	5.0	3.2
T25-6B	6.0	3.4

HEAT SINK :
 MATERIAL : A 6063
 FINISH : BLACK ANODIZE

Dimensions : mm

DATA

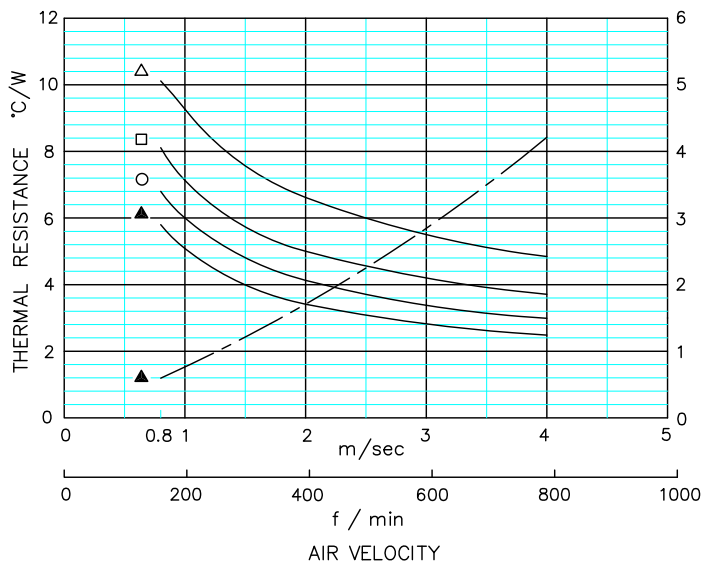

- Thermal Resistance (Ducted)
 (Solid Line ———)
- Pressure Drop
 (Center Line - - -)

- △ T25-3B
- T25-4B
- T25-5B
- ▲ T25-6B

■ Based on Alpha's Standard Test Procedure. (Refer to page marked Technical Information.)
 Dummy Heater Size : □ 12.7(mm)

Alpha Company Ltd.

256-1 UEDA, NUMAZU-CITY SHIZUOKA-PREF., JAPAN
 PHONE +81(55)966 0789
 FAX +81(55)966 9192
 E mail : alpha@micforg.co.jp
 URL : http://www.micforg.co.jp

Alpha Novatech, Inc. - a subsidiary of Alpha Company.

473 Sapena Ct. #12 Santa Clara, CA 95054 USA
 PHONE +1(408)567-8082
 FAX +1(408)567-8053
 E mail : sales@alphanovatech.com
 URL : http://www.alphanovatech.com

ALPHA

Thin fin and Low profile Heat Sink

T30

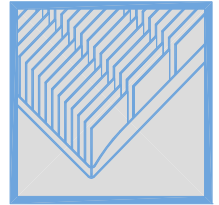

DIM

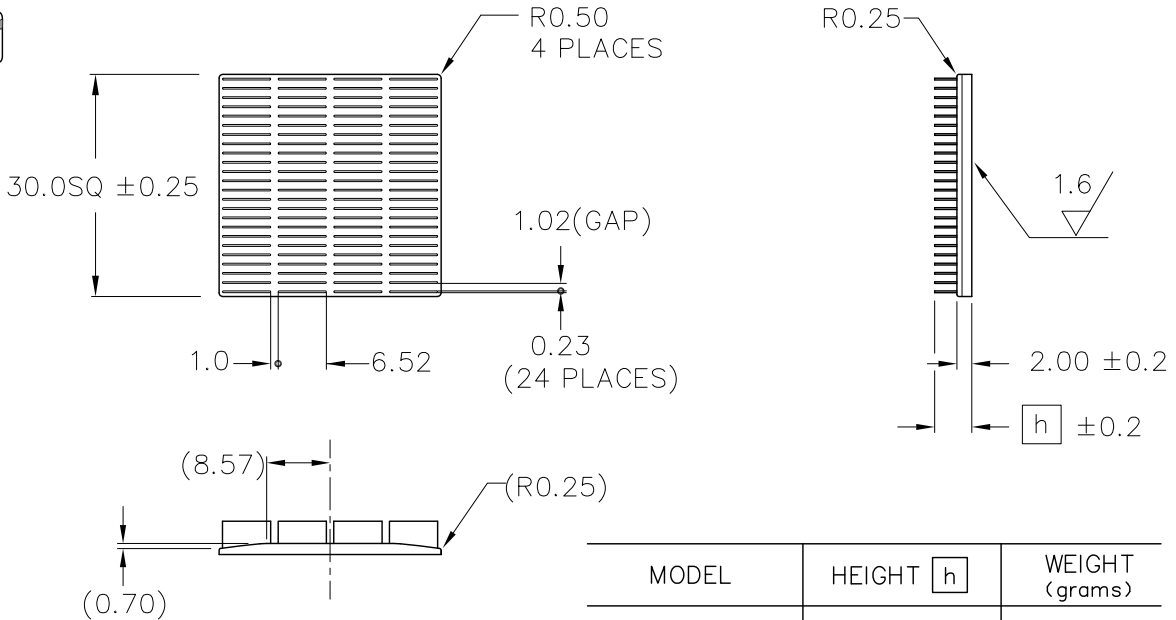

HEAT SINK
 MATERIAL : A 6063
 FINISH : BLACK ANODIZE

MODEL	HEIGHT [h]	WEIGHT (grams)
T30-3B	3.0	5.0
T30-4B	4.0	5.4
T30-5B	5.0	5.8
T30-6B	6.0	6.2

Dimensions : mm

DATA

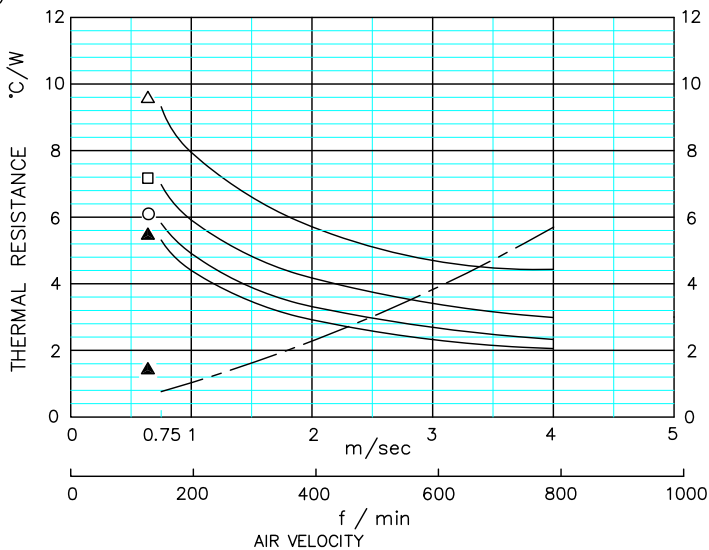

- Thermal Resistance (Ducted)
 (Solid Line ———)
- Pressure Drop
 (Center Line - - -)

- △ T30-3B
- T30-4B
- T30-5B
- ▲ T30-6B

■ Based on Alpha's Standard Test Procedure. (Refer to page marked Technical Information.)
 Dummy Heater Size : □ 12.7(mm)

Alpha Company Ltd.

256-1 UEDA, NUMAZU-CITY SHIZUOKA-PREF., JAPAN
 PHONE +81(55)966 0789
 FAX +81(55)966 9192
 E mail : alpha@micforg.co.jp
 URL : http://www.micforg.co.jp

Alpha Novatech, Inc. - a subsidiary of Alpha Company.

473 Sapena Ct. #12 Santa Clara, CA 95054 USA
 PHONE +1(408)567-8082
 FAX +1(408)567-8053
 E mail : sales@alphanovatech.com
 URL : http://www.alphanovatech.com

ALPHA Thin fin and Low profile Heat Sink

T35

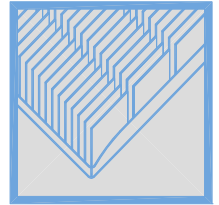

DIM

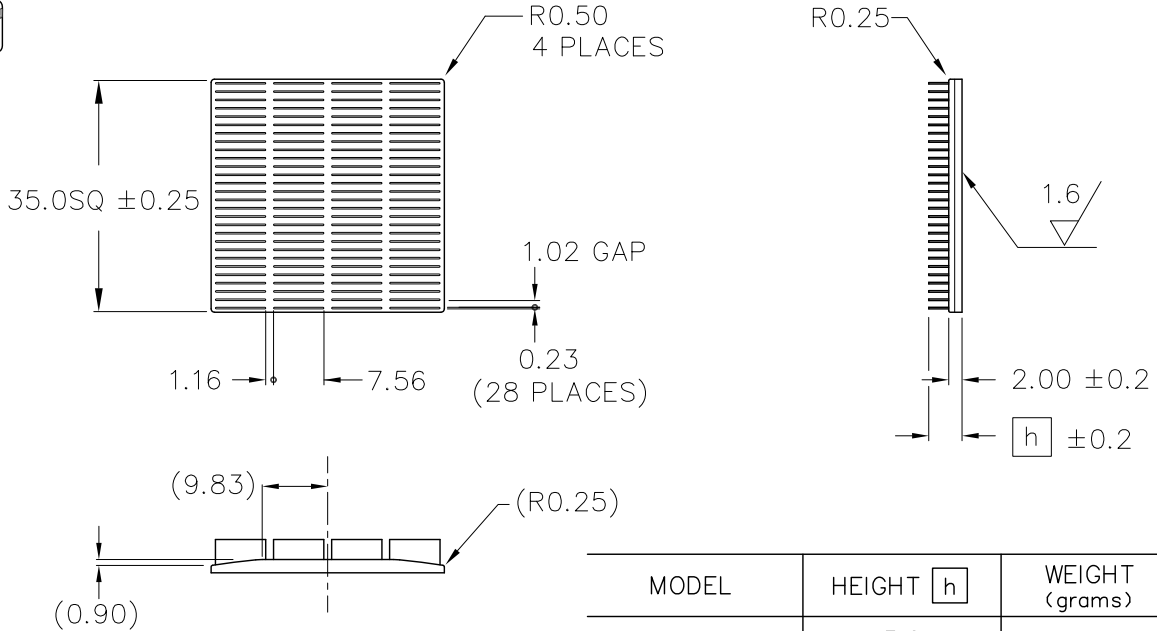

HEAT SINK
 MATERIAL : A 6063
 FINISH : BLACK ANODIZE

MODEL	HEIGHT h	WEIGHT (grams)
T35-3B	3.0	6.85
T35-4B	4.0	7.4
T35-5B	5.0	7.95
T35-6B	6.0	8.5

Dimensions : mm

DATA

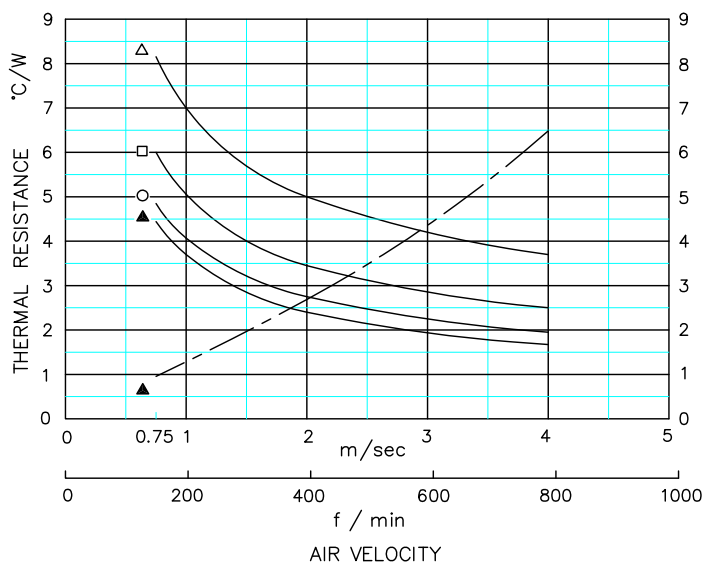

- Thermal Resistance (Ducted)
(Solid Line ———)
- Pressure Drop
(Center Line - - -)

- △ T35-3B
- T35-4B
- T35-5B
- ▲ T35-6B

■ Based on Alpha's Standard Test Procedure. (Refer to page marked Technical Information.)
 Dummy Heater Size : □ 12.7(mm)

Alpha Company Ltd.

256-1 UEDA, NUMAZU-CITY SHIZUOKA-PREF., JAPAN
 PHONE +81(55)966 0789
 FAX +81(55)966 9192
 E mail : alpha@micforg.co.jp
 URL : http://www.micforg.co.jp

Alpha Novatech, Inc. - a subsidiary of Alpha Company.

473 Sapena Ct. #12 Santa Clara, CA 95054 USA
 PHONE +1(408)567-8082
 FAX +1(408)567-8053
 E mail : sales@alphanovatech.com
 URL : http://www.alphanovatech.com

ALPHA Thin fin and Low profile Heat Sink

T40

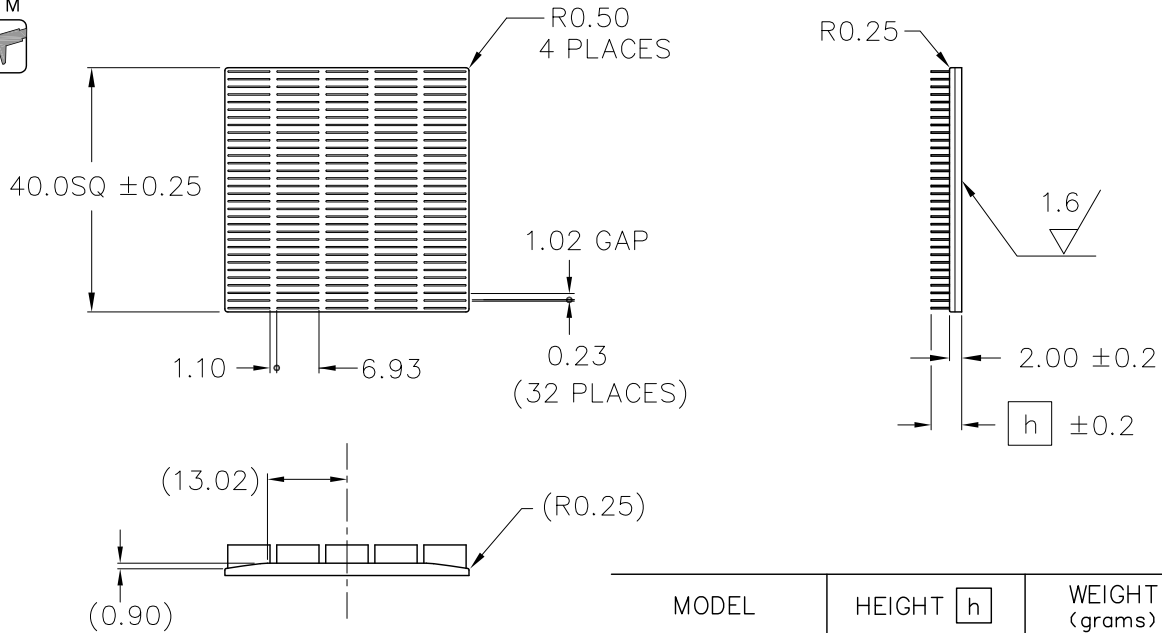
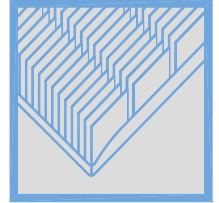

HEAT SINK
 MATERIAL : A 6063
 FINISH : BLACK ANODIZE

MODEL	HEIGHT h	WEIGHT (grams)
T40-3B	3.0	7.2
T40-4B	4.0	8.6
T40-5B	5.0	10.0
T40-6B	6.0	11.4

Dimensions : mm

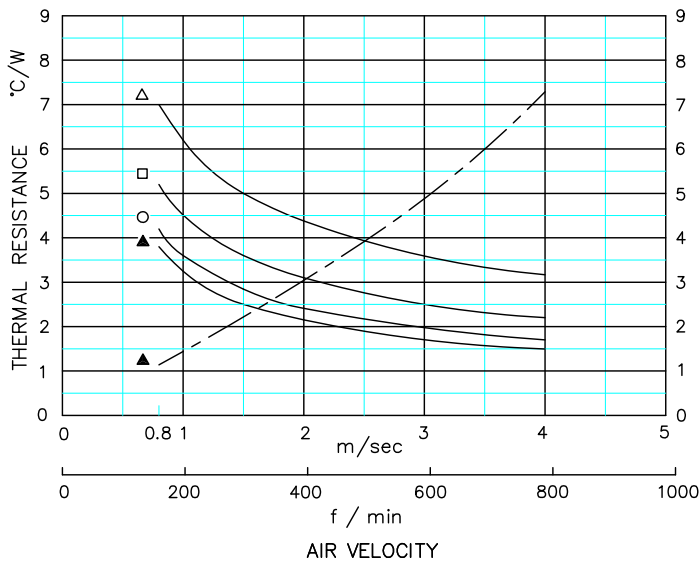

● Thermal Resistance (Ducted)
 (Solid Line)

● Pressure Drop
 (Center Line)

△ T40-3B
 □ T40-4B
 ○ T40-5B
 ▲ T40-6B

■ Based on Alpha's Standard Test Procedure. (Refer to page marked Technical Information.)
 Dummy Heater Size : □ 12.7(mm)

Alpha Company Ltd.

256-1 UEDA, NUMAZU-CITY SHIZUOKA-PREF., JAPAN
 PHONE +81(55)966 0789
 FAX +81(55)966 9192
 E mail : alpha@micforg.co.jp
 URL : http://www.micforg.co.jp

Alpha Novatech, Inc. - a subsidiary of Alpha Company.

473 Sapena Ct. #12 Santa Clara, CA 95054 USA
 PHONE +1(408)567-8082
 FAX +1(408)567-8053
 E mail : sales@alphanovatech.com
 URL : http://www.alphanovatech.com