

UBM_S Series
UBH_S Series
UB_S Series

Low Pressure Drop and
Low Thermal Resistance Heat Sink
with Attachment Holes

ALPHA

ALPHA

Low Pressure Drop and
Low Thermal Resistance Heat Sink
with attachment holes

UBM50S

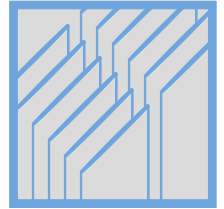

DIM

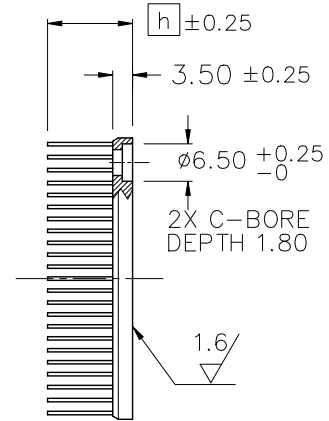
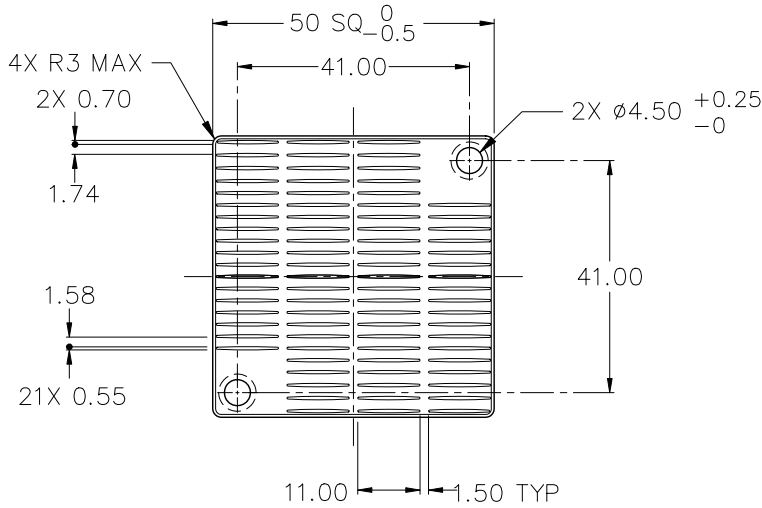

MODEL	HEIGHT h	WEIGHT (grams)
UBM50S-15B	15	34.8
UBM50S-20B	20	43.6
UBM50S-25B	25	49.8

MATERIAL : A 6063
FINISH : BLACK ANODIZE
DIMENSIONS : mm

DATA

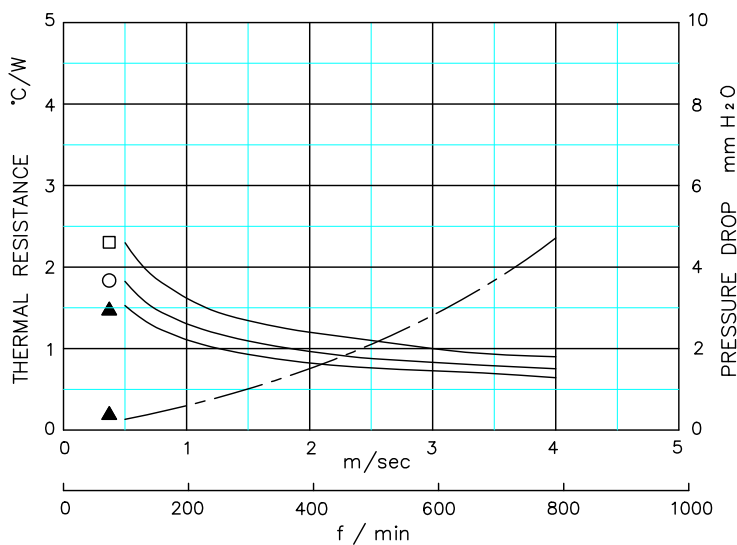

AIR VELOCITY: DUCTED CONDITION

□ UBM50S-15B
 ○ UBM50S-20B
 ▲ UBM50S-25B
 ● DUCTED CONDITION
 DUMMY HEATER SIZE: 12.7 SQ
 THERMAL RESISTANCE ———
 PRESURE DROP - - - - -

■ BASED ON ALPHA'S STANDARD TEST PROCEDURE. REFER TO TECHNICAL INFORMATION.

Alpha Company Ltd.

256-1 UEDA, NUMAZU-CITY SHIZUOKA-PREF., JAPAN
PHONE +81(55)966 0789
FAX +81(55)966 9192
E mail : alpha@micforg.co.jp
URL : <http://www.micforg.co.jp>

Alpha Novatech, Inc. - a subsidiary of Alpha Company Ltd.

473 Sapena Ct. #12 Santa Clara, CA 95054 USA
PHONE +1(408)567-8082
FAX +1(408)567-8053
E mail : sales@alphanovatech.com
URL : <http://www.alphanovatech.com>

ALPHA

Low Pressure Drop and
Low Thermal Resistance Heat Sink
with attachment holes

UBM54S

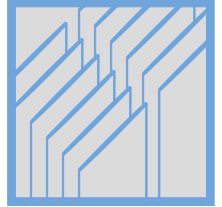

DIM

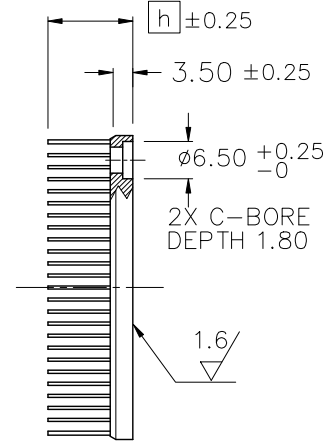
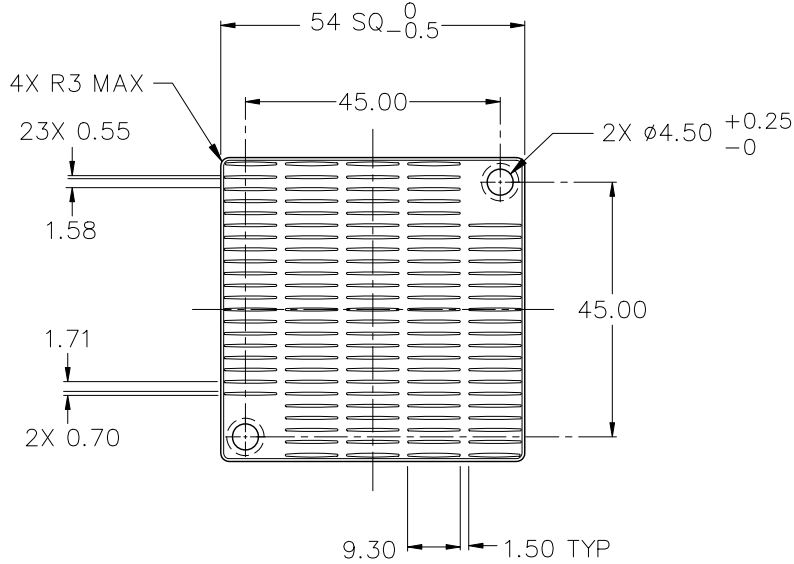

MODEL	HEIGHT [h]	WEIGHT (grams)
UBM54S-15B	15	46.4
UBM54S-20B	20	53.3
UBM54S-25B	25	60.2

MATERIAL : A 6063
FINISH : BLACK ANODIZE
DIMENSIONS : mm

DATA

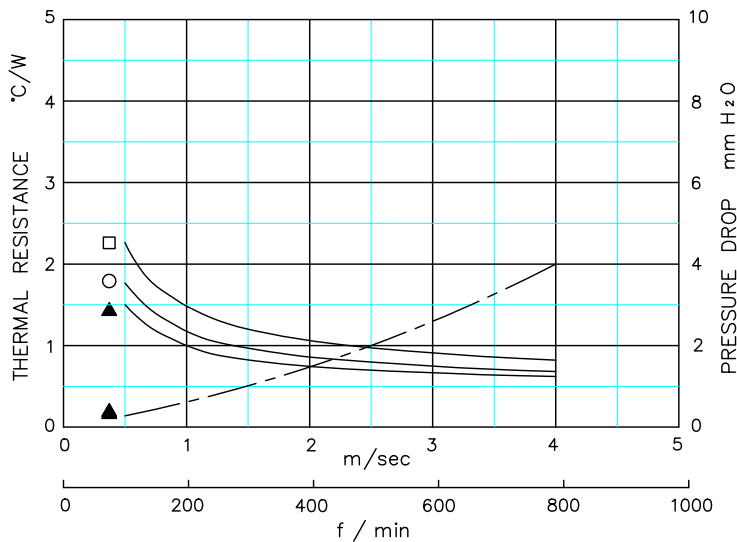

□ UBM54S-15B
○ UBM54S-20B
▲ UBM54S-25B

● DUCTED CONDITION
DUMMY HEATER SIZE: 12.7 SQ
THERMAL RESISTANCE ———
PRESURE DROP - - - - -

■ BASED ON ALPHA'S STANDARD TEST PROCEDURE.
REFER TO TECHNICAL INFORMATION.

Alpha Company Ltd.

256-1 UEDA, NUMAZU-CITY SHIZUOKA-PREF., JAPAN
PHONE +81(55)966 0789
FAX +81(55)966 9192
E mail : alpha@micforg.co.jp
URL : http://www.micforg.co.jp

Alpha Novatech, Inc. - a subsidiary of Alpha Company Ltd.

473 Sapena Ct. #12 Santa Clara, CA 95054 USA
PHONE +1(408)567-8082
FAX +1(408)567-8053
E mail : sales@alphanovatech.com
URL : http://www.alphanovatech.com

ALPHA

Low Pressure Drop and
Low Thermal Resistance Heat Sink
with attachment holes

UBM60S

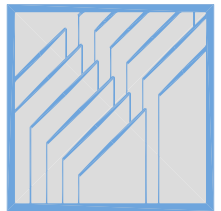

DIM

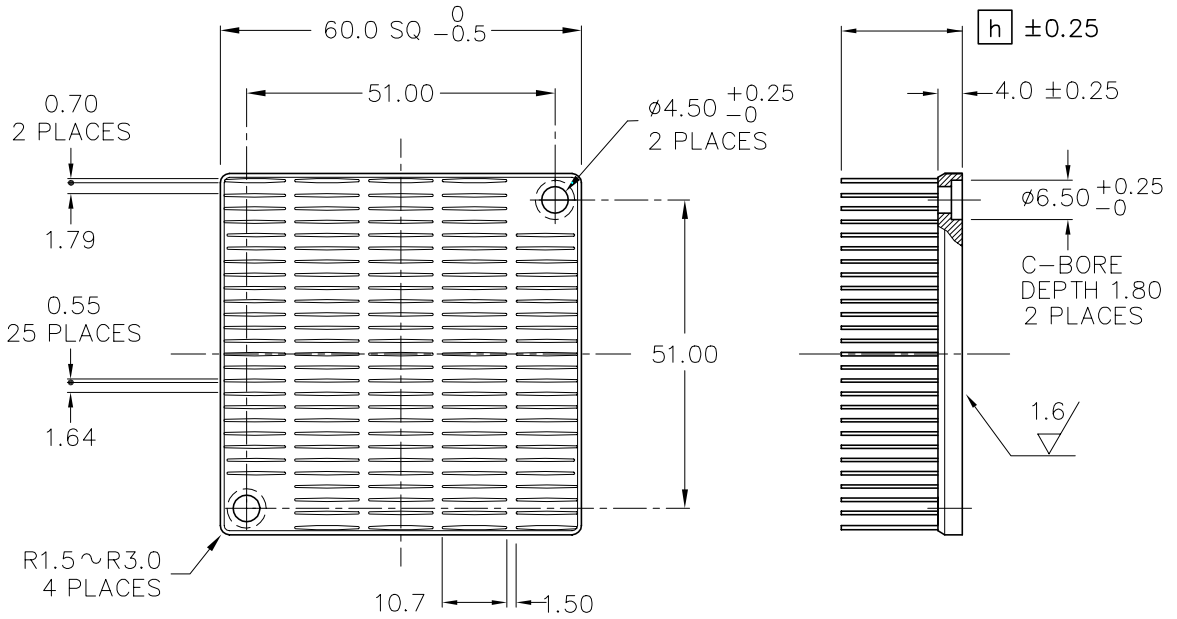

MODEL	HEIGHT [h]	WEIGHT (grams)
UBM60S-15B	15	56.8
UBM60S-20B	20	64.8
UBM60S-25B	25	72.8

MATERIAL : A 6063
FINISH : BLACK ANODIZE
DIMENSIONS : mm

DATA

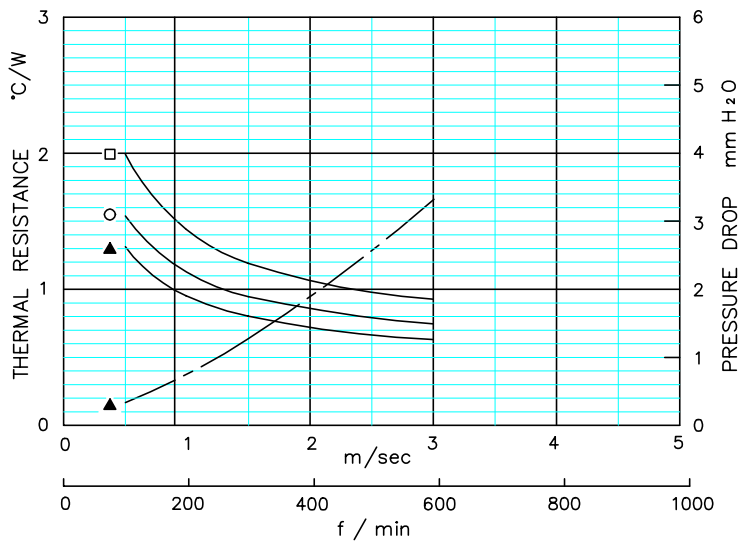

□ UBM60S-15B
○ UBM60S-20B
▲ UBM60S-25B

● DUCTED CONDITION
DUMMY HEATER SIZE: 12.7 SQ
THERMAL RESISTANCE _____
PRESURE DROP - - - - -

AIR VELOCITY: DUCTED CONDITION

■ BASED ON ALPHA'S STANDARD TEST PROCEDURE. REFER TO TECHNICAL INFORMATION.

Alpha Company Ltd.

256-1 UEDA, NUMAZU-CITY SHIZUOKA-PREF., JAPAN
PHONE +81(55)966 0789
FAX +81(55)966 9192
E mail : alpha@micforg.co.jp
URL : <http://www.micforg.co.jp>

Alpha Novatech, Inc. - a subsidiary of Alpha Company.

473 Sapena Ct. #12 Santa Clara, CA 95054 USA
PHONE +1(408)567-8082
FAX +1(408)567-8053
E mail : sales@alphanovatech.com
URL : <http://www.alphanovatech.com>

ALPHA

Low Pressure Drop and
Low Thermal Resistance Heat Sink
with attachment holes

UBM70S

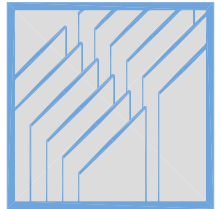

DIM

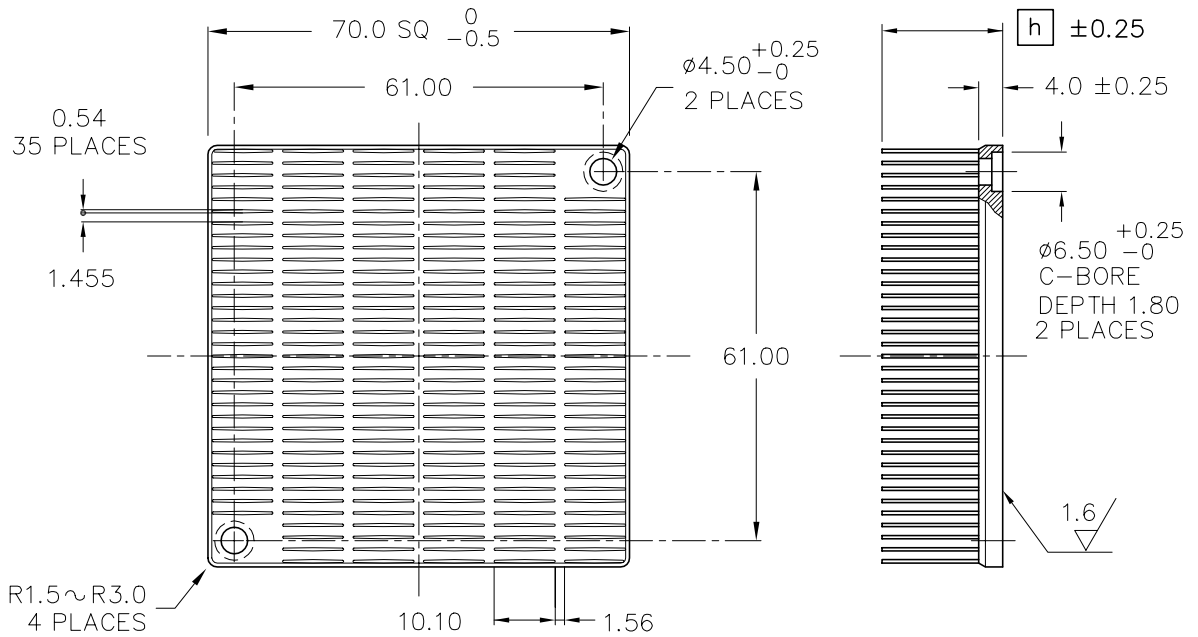

MODEL	HEIGHT [h]	WEIGHT (grams)
UBM70S-15B	15	97.0
UBM70S-20B	20	108.7
UBM70S-25B	25	120.4

MATERIAL : A 6063
FINISH : BLACK ANODIZE
DIMENSIONS : mm

DATA

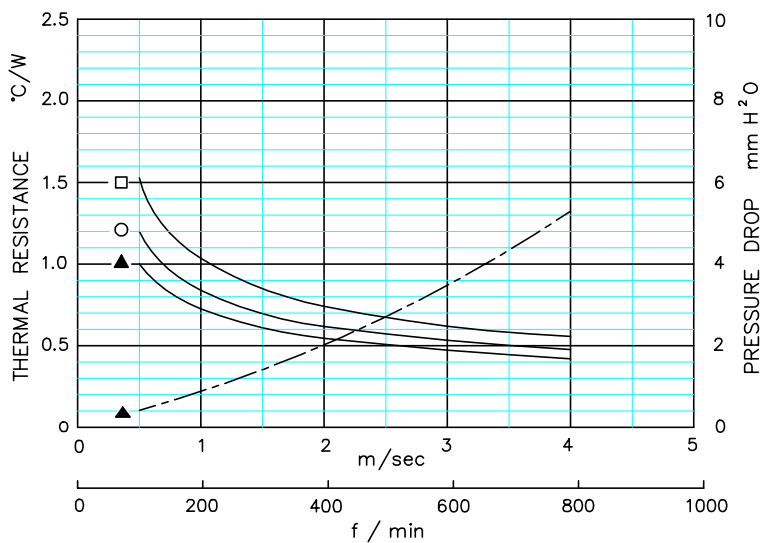

□ UBM70S-15B
○ UBM70S-20B
▲ UBM70S-25B

● DUCTED CONDITION
DUMMY HEATER SIZE: 12.7 SQ
THERMAL RESISTANCE ———
PRESSURE DROP - - - - -

AIR VELOCITY: DUCTED CONDITION

■ BASED ON ALPHA'S STANDARD TEST PROCEDURE. REFER TO TECHNICAL INFORMATION.

Alpha Company Ltd.

256-1 UEDA, NUMAZU-CITY SHIZUOKA-PREF., JAPAN
PHONE +81(55)966 0789
FAX +81(55)966 9192
E mail : alpha@micforg.co.jp
URL : <http://www.micforg.co.jp>

Alpha Novatech, Inc. - a subsidiary of Alpha Company.

473 Sapena Ct. #12 Santa Clara, CA 95054 USA
PHONE +1(408)567-8082
FAX +1(408)567-8053
E mail : sales@alphanovatech.com
URL : <http://www.alphanovatech.com>

REF



● BOARD KEEPOUT PATTERNS

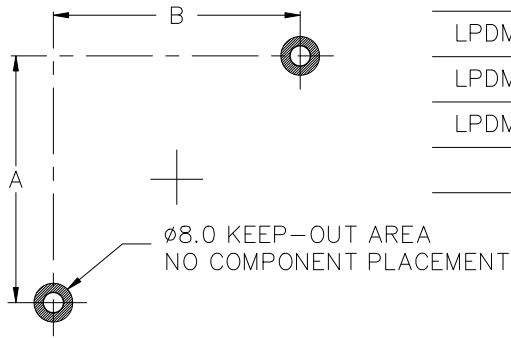

LPDM50S AND UBM50S	41.0	41.0
LPDM54S AND UBM54S	45.0	45.0
LPDM60S AND UBM60S	51.0	51.0
LPDM70S AND UBM70S	61.0	61.0
MODEL	A	B

● INSTALLATION

USE HEX NUTS M3x0.5

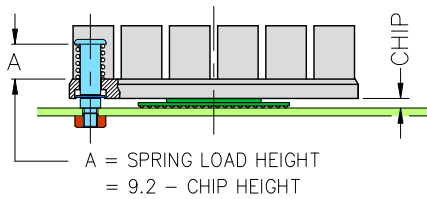

REQUIRES $\phi 3.30$ THRU HOLES IN BOARD.
RECOMMENDED P.C.B THICKNESS 1.6mm.
MINIMUM CHIP HEIGHT 1.5mm.

USE *MAC8* TH-1.6-XX-M3

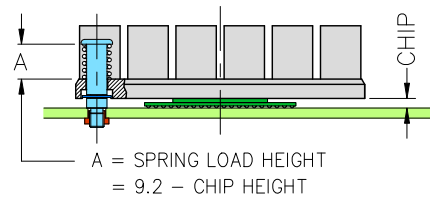

REQUIRES $\phi 3.70$ THRU HOLES IN BOARD.
MAC8 THREAD INSERT NEED THE SOLDERING.
RECOMMENDED P.C.B THICKNESS
MINIMUM 1.6mm ~ MAXIMUM 3.7mm
MINIMUM CHIP HEIGHT 1.5mm.

USE CUSTOM BACKING-PLATE

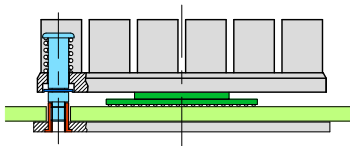

CUSTOM DESIGN FOR ANY PCB THICKNESS.

SHOULDER-SCREW/RETAINING RING E-2.5

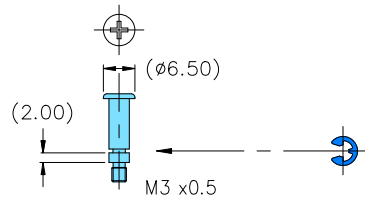

REFER TO THE DRAWING FOR DETAIL SPECIFICATION.

ALPHA

Low Pressure Drop and
Low Thermal Resistance Heat Sink
with attachment holes

UBH50S

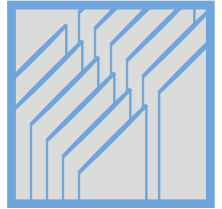

DIM

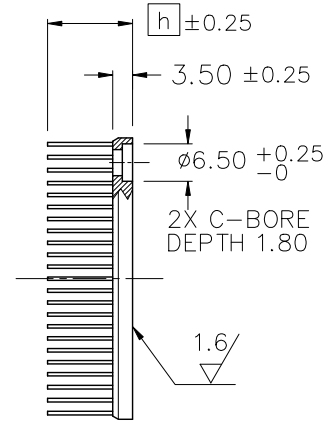
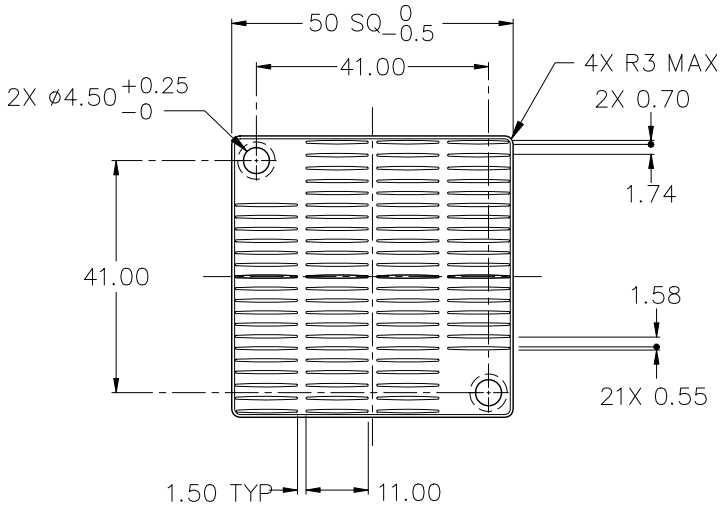

MODEL	HEIGHT [h]	WEIGHT (grams)
UBH50S-15B	15	34.8
UBH50S-20B	20	43.6
UBH50S-25B	25	49.8

MATERIAL : A 6063
FINISH : BLACK ANODIZE
DIMENSIONS : mm

DATA

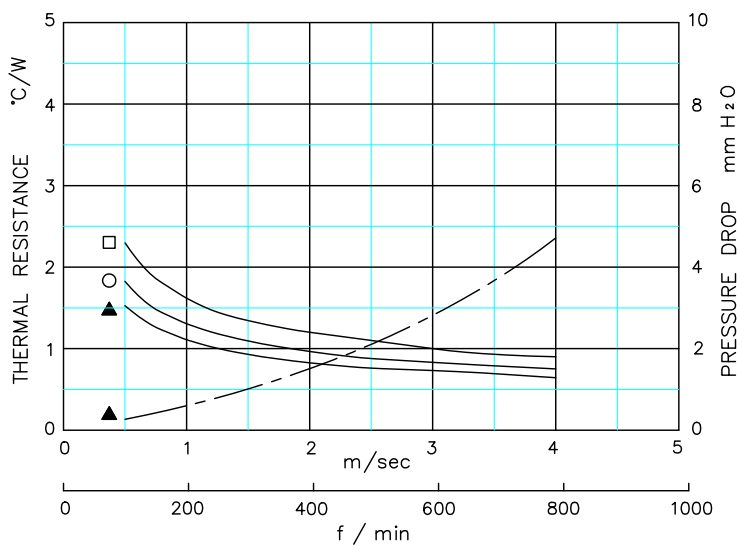

□ UBH50S-15B
○ UBH50S-20B
▲ UBH50S-25B

● DUCTED CONDITION
DUMMY HEATER SIZE: 12.7 SQ
THERMAL RESISTANCE ———
PRESURE DROP - - - - -

■ BASED ON ALPHA'S STANDARD TEST PROCEDURE.
REFER TO TECHNICAL INFORMATION.

Alpha Company Ltd.

256-1 UEDA, NUMAZU-CITY SHIZUOKA-PREF., JAPAN
PHONE +81(55)966 0789
FAX +81(55)966 9192
E mail : alpha@micforg.co.jp
URL : <http://www.micforg.co.jp>

Alpha Novatech, Inc. - a subsidiary of Alpha Company Ltd.

473 Sapena Ct. #12 Santa Clara, CA 95054 USA
PHONE +1(408)567-8082
FAX +1(408)567-8053
E mail : sales@alphanovatech.com
URL : <http://www.alphanovatech.com>

ALPHA

Low Pressure Drop and
Low Thermal Resistance Heat Sink
with attachment holes

UBH54S

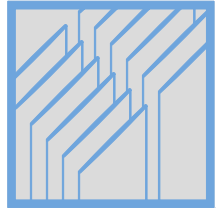

DIM

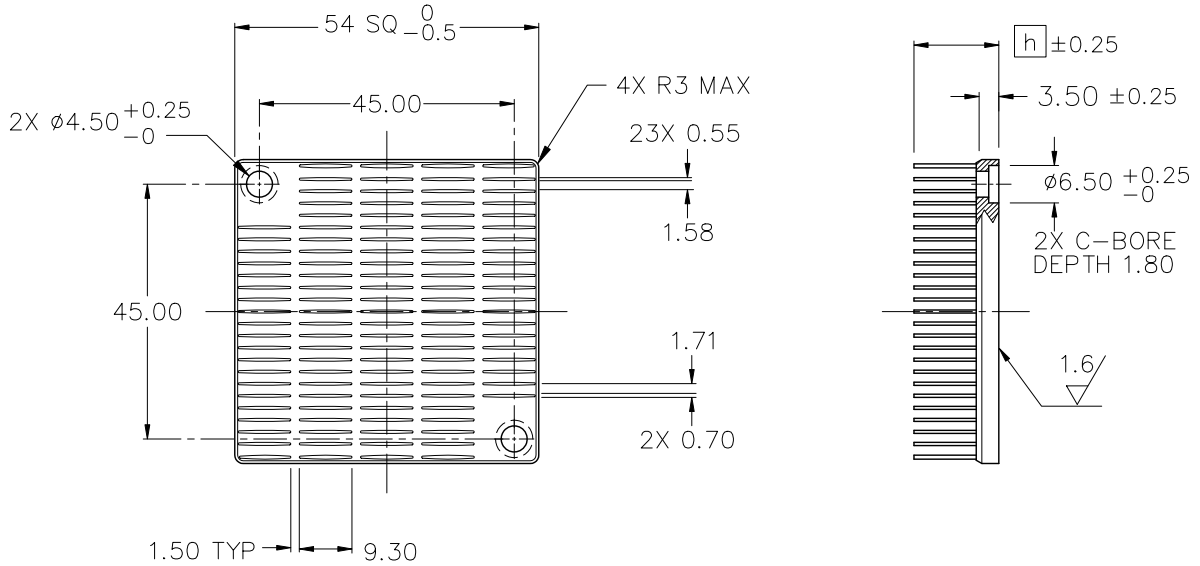

MODEL	HEIGHT [h]	WEIGHT (grams)
UBH54S-15B	15	46.4
UBH54S-20B	20	53.3
UBH54S-25B	25	60.2

MATERIAL : A 6063
FINISH : BLACK ANODIZE
DIMENSIONS : mm

DATA

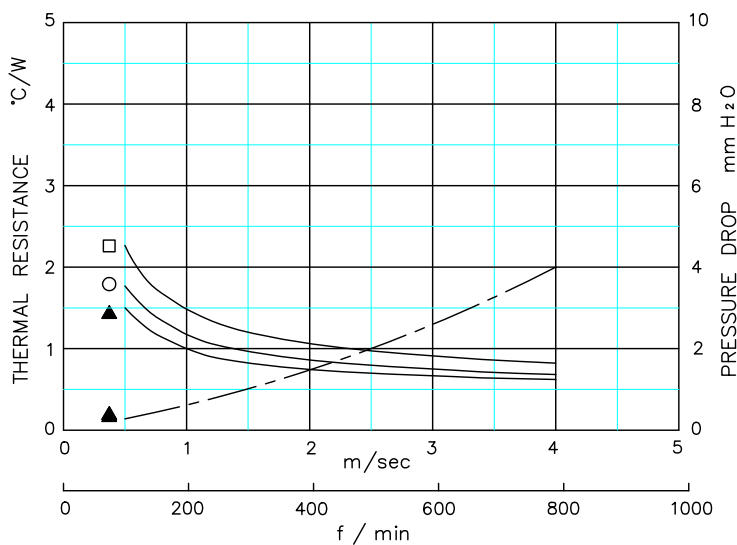

AIR VELOCITY: DUCTED CONDITION

■ BASED ON ALPHA'S STANDARD TEST PROCEDURE. REFER TO TECHNICAL INFORMATION.

Alpha Company Ltd.

256-1 UEDA, NUMAZU-CITY SHIZUOKA-PREF., JAPAN
PHONE +81(55)966 0789
FAX +81(55)966 9192
E mail : alpha@micforg.co.jp
URL : <http://www.micforg.co.jp>

Alpha Novatech, Inc. - a subsidiary of Alpha Company Ltd.

473 Sapena Ct. #12 Santa Clara, CA 95054 USA
PHONE +1(408)567-8082
FAX +1(408)567-8053
E mail : sales@alphanovatech.com
URL : <http://www.alphanovatech.com>

ALPHA

Low Pressure Drop and
Low Thermal Resistance Heat Sink
with attachment holes

UBH60S

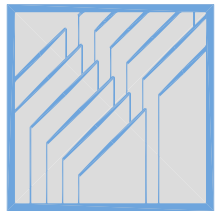

DIM

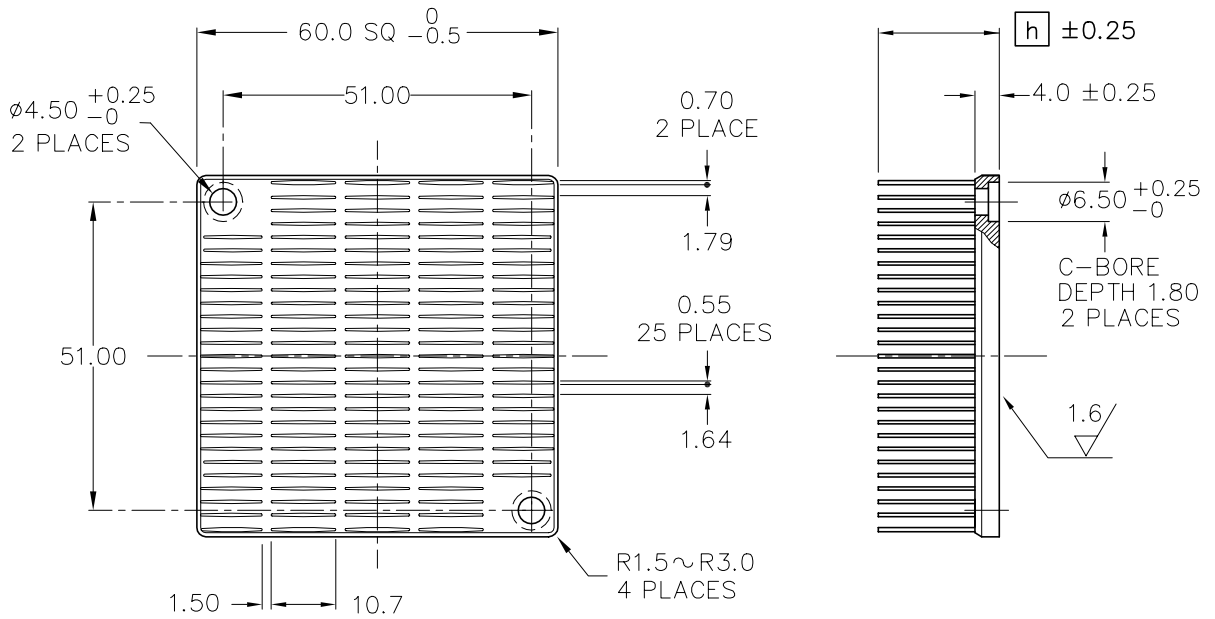

MODEL	HEIGHT [h]	WEIGHT (grams)
UBH60S-15B	15	56.8
UBH60S-20B	20	64.8
UBH60S-25B	25	72.8

MATERIAL : A 6063
FINISH : BLACK ANODIZE
DIMENSIONS : mm

DATA

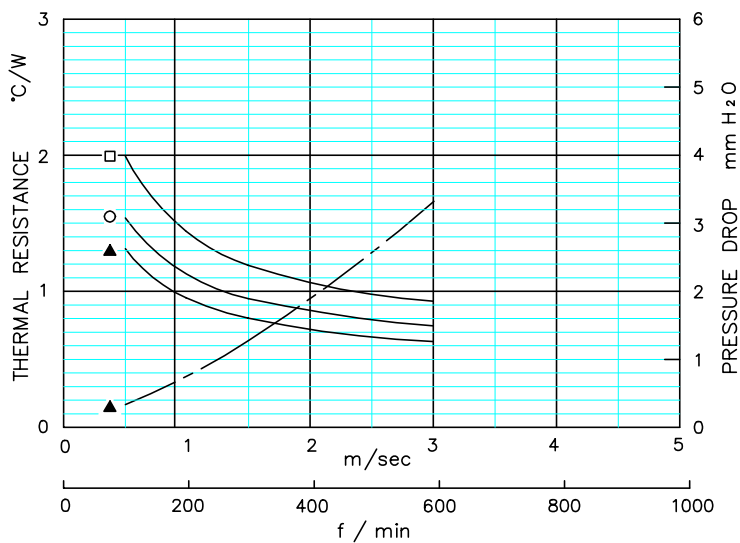

UBH60S-15B
 UBH60S-20B
 UBH60S-25B

DUCTED CONDITION
 DUMMY HEATER SIZE: 12.7 SQ
 THERMAL RESISTANCE
 PRESURE DROP

BASED ON ALPHA'S STANDARD TEST PROCEDURE.
 REFER TO TECHNICAL INFORMATION.

AIR VELOCITY: DUCTED CONDITION

Alpha Company Ltd.

256-1 UEDA, NUMAZU-CITY SHIZUOKA-PREF., JAPAN
 PHONE +81(55)966 0789
 FAX +81(55)966 9192
 E mail : alpha@micforg.co.jp
 URL : <http://www.micforg.co.jp>

Alpha Novatech, Inc. - a subsidiary of Alpha Company.

473 Sapena Ct. #12 Santa Clara, CA 95054 USA
 PHONE +1(408)567-8082
 FAX +1(408)567-8053
 E mail : sales@alphanovatech.com
 URL : <http://www.alphanovatech.com>

ALPHA

Low Pressure Drop and
Low Thermal Resistance Heat Sink
with attachment holes

UBH70S

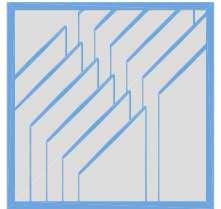

DIM

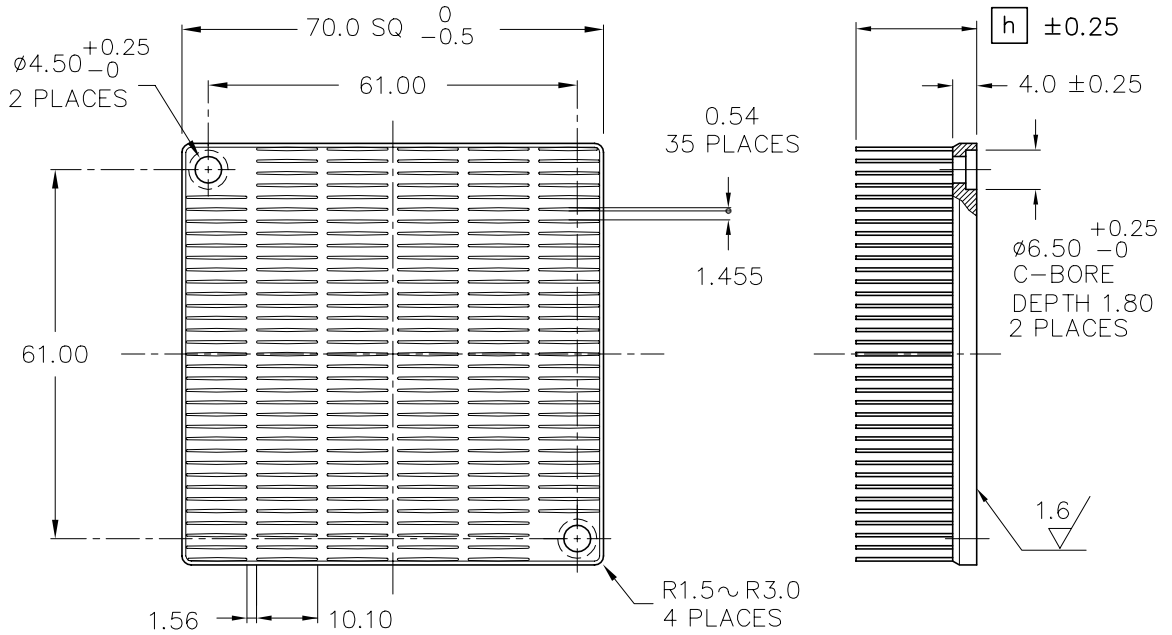

MODEL	HEIGHT [h]	WEIGHT (grams)
UBH70S-15B	15	97.0
UBH70S-20B	20	108.7
UBH70S-25B	25	120.4

MATERIAL : A 6063
FINISH : BLACK ANODIZE
DIMENSIONS : mm

DATA

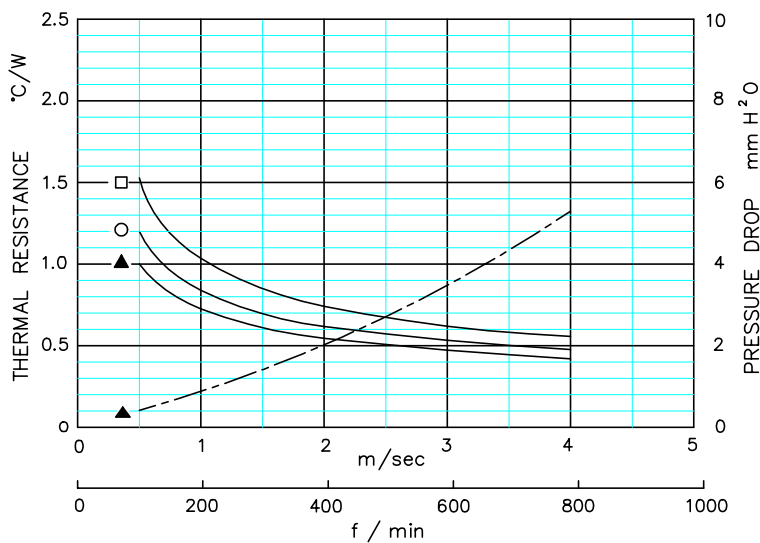

□ UBH70S-15B
 ○ UBH70S-20B
 ▲ UBH70S-25B

● DUCTED CONDITION
 DUMMY HEATER SIZE: 12.7 SQ
 THERMAL RESISTANCE ———
 PRESSURE DROP - - - -

■ BASED ON ALPHA'S STANDARD TEST PROCEDURE.
 REFER TO TECHNICAL INFORMATION.

Alpha Company Ltd.

256-1 UEDA, NUMAZU-CITY SHIZUOKA-PREF., JAPAN
 PHONE +81(55)966 0789
 FAX +81(55)966 9192
 E mail : alpha@micforg.co.jp
 URL : <http://www.micforg.co.jp>

Alpha Novatech, Inc. - a subsidiary of Alpha Company.

473 Sapena Ct. #12 Santa Clara, CA 95054 USA
 PHONE +1(408)567-8082
 FAX +1(408)567-8053
 E mail : sales@alphanovatech.com
 URL : <http://www.alphanovatech.com>

REF



● BOARD KEEPOUT PATTERNS

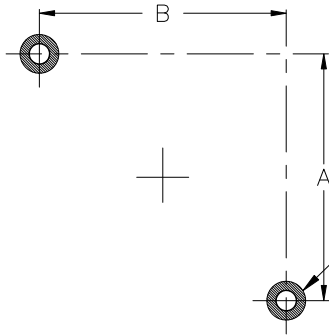

LPDH50S AND UBH50S	41.0	41.0
LPDH54S AND UBH54S	45.0	45.0
LPDH60S AND UBH60S	51.0	51.0
LPDH70S AND UBH70S	61.0	61.0
MODEL	A	B

∅8.0 KEEP-OUT AREA
NO COMPONENT PLACEMENT

● INSTALLATION

USE HEX NUTS M3x0.5

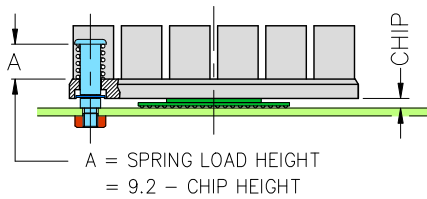

REQUIRES ∅3.30 THRU HOLES IN BOARD.
RECOMMENDED P.C.B THICKNESS 1.6mm.
MINIMUM CHIP HEIGHT 1.5mm.

USE MAC8 TH-1.6-XX-M3

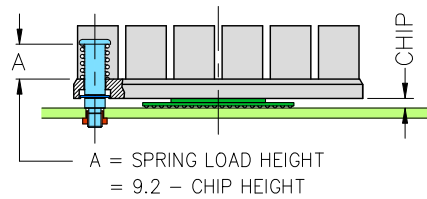

REQUIRES ∅3.70 THRU HOLES IN BOARD.
MAC8 THREAD INSERT NEED THE SOLDERING.
RECOMMENDED P.C.B THICKNESS
MINIMUM 1.6mm ~ MAXIMUM 3.7mm
MINIMUM CHIP HEIGHT 1.5mm.

USE CUSTOM BACKING-PLATE

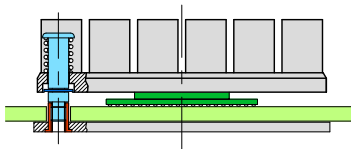

CUSTOM DESIGN FOR ANY PCB THICKNESS.

SHOULDER-SCREW/RETAINING RING E-2.5

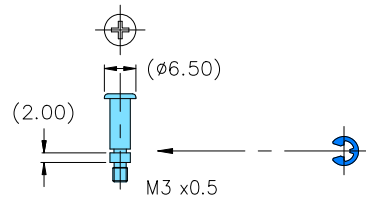

REFER TO THE DRAWING FOR DETAIL SPECIFICATION.

ALPHA

Low Pressure Drop and
Low Thermal Resistance Heat Sink
with attachment holes

UB80S

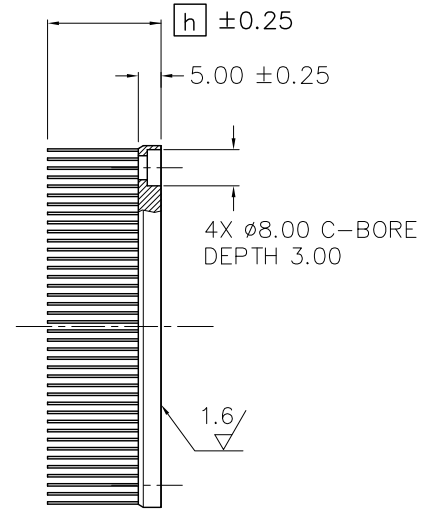
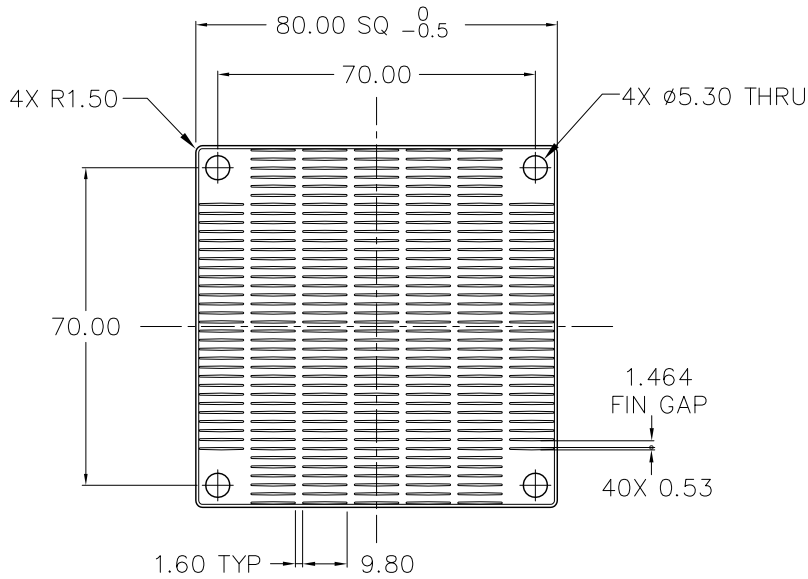
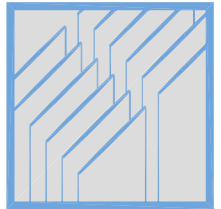

MODEL	HEIGHT [h]	WEIGHT (grams)
UB80S-15B	15	114.6
UB80S-20B	20	130.3
UB80S-25B	25	146.1
UB80S-30B	30	164.8

MATERIAL : A 6063
FINISH : BLACK ANODIZE
DIMENSIONS : mm

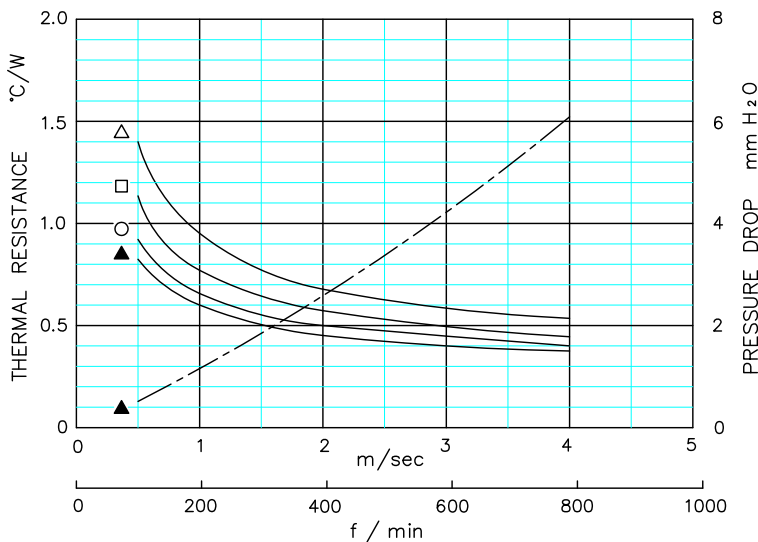

- △ UB80S-15B
- UB80S-20B
- UB80S-25B
- ▲ UB80S-30B

● DUCTED CONDITION
DUMMY HEATER SIZE: 12.7 SQ
THERMAL RESISTANCE ———
PRESSURE DROP - - - - -

AIR VELOCITY: DUCTED CONDITION

■ BASED ON ALPHA'S STANDARD TEST PROCEDURE.
REFER TO TECHNICAL INFORMATION.

Alpha Company Ltd.

256-1 UEDA, NUMAZU-CITY SHIZUOKA-PREF., JAPAN
PHONE +81(55)966 0789
FAX +81(55)966 9192
E mail : alpha@micforg.co.jp
URL : <http://www.micforg.co.jp>

Alpha Novatech, Inc. - a subsidiary of Alpha Company.

473 Sapena Ct. #12 Santa Clara, CA 95054 USA
PHONE +1(408)567-8082
FAX +1(408)567-8053
E mail : sales@alphanovatech.com
URL : <http://www.alphanovatech.com>

ALPHA

Low Pressure Drop and
Low Thermal Resistance Heat Sink
with attachment holes

UB90S

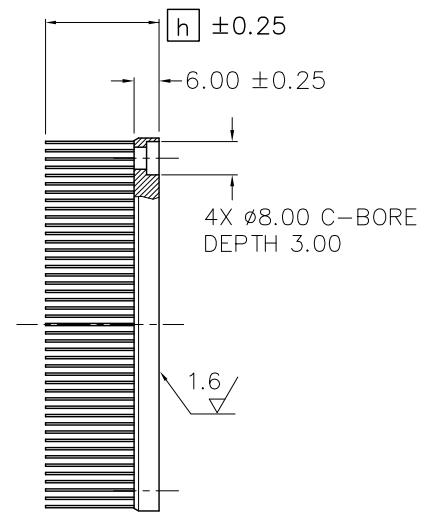
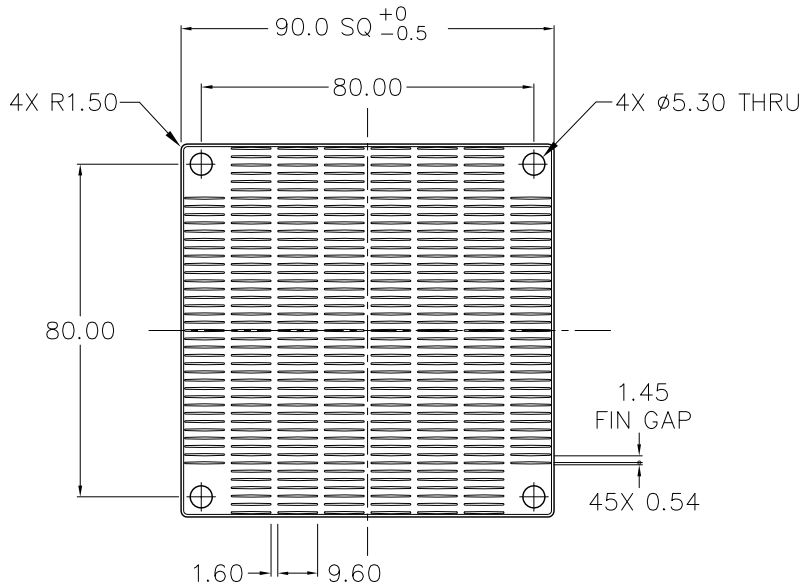
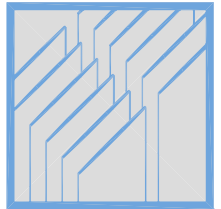

MODEL	HEIGHT [h]	WEIGHT (grams)
UB90S-15B	15	164.2
UB90S-20B	20	184.7
UB90S-25B	25	205.2
UB90S-30B	30	225.7

MATERIAL : A 6063
FINISH : BLACK ANODIZE
DIMENSIONS : mm

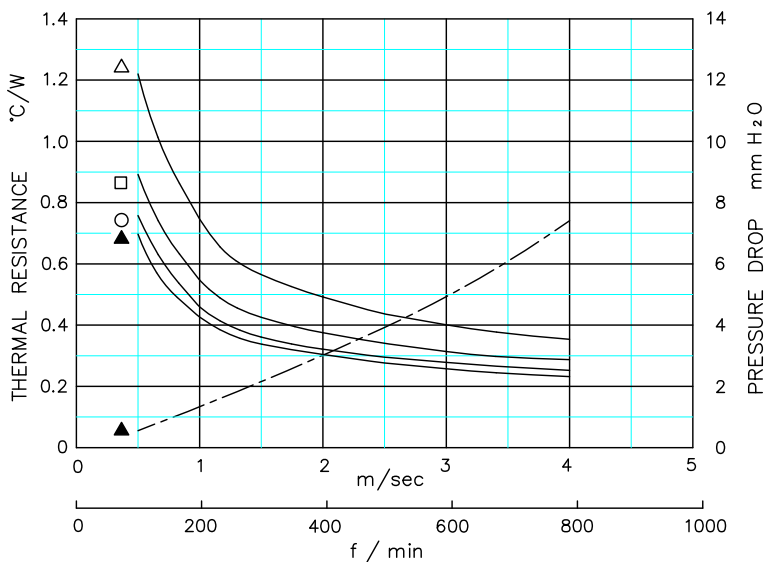

- △ UB90S-15B
- UB90S-20B
- UB90S-25B
- ▲ UB90S-30B

● DUCTED CONDITION
DUMMY HEATER SIZE: 25 SQ
THERMAL RESISTANCE ———
PRESSURE DROP - - - - -

■ BASED ON ALPHA'S STANDARD TEST PROCEDURE.
REFER TO TECHNICAL INFORMATION.

Alpha Company Ltd.

256-1 UEDA, NUMAZU-CITY SHIZUOKA-PREF., JAPAN
PHONE +81(55)966 0789
FAX +81(55)966 9192
E mail : alpha@micforg.co.jp
URL : <http://www.micforg.co.jp>

Alpha Novatech, Inc. - a subsidiary of Alpha Company.

473 Sapena Ct. #12 Santa Clara, CA 95054 USA
PHONE +1(408)567-8082
FAX +1(408)567-8053
E mail : sales@alphanovatech.com
URL : <http://www.alphanovatech.com>

ALPHA

Low Pressure Drop and
Low Thermal Resistance Heat Sink
with attachment holes

UB100S

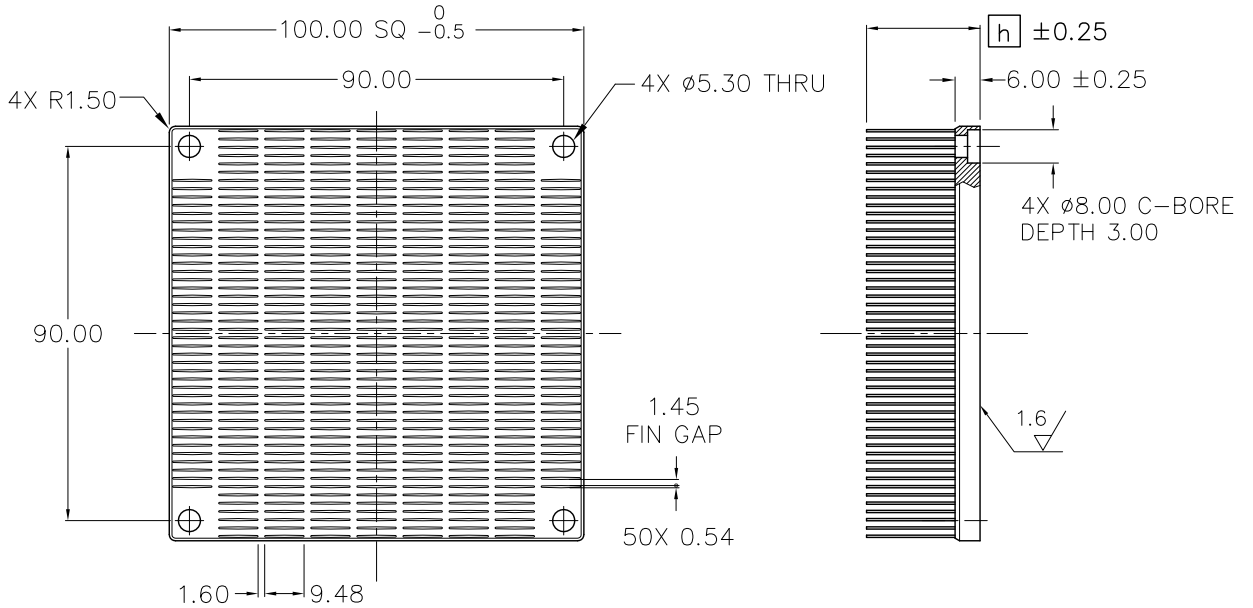
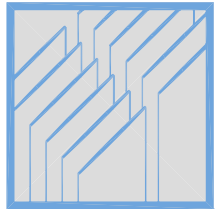

MODEL	HEIGHT h	WEIGHT (grams)
UB100S-15B	15	204.0
UB100S-20B	20	229.7
UB100S-25B	25	255.4
UB100S-30B	30	281.0

MATERIAL : A 6063
 FINISH : BLACK ANODIZE
 DIMENSIONS : mm

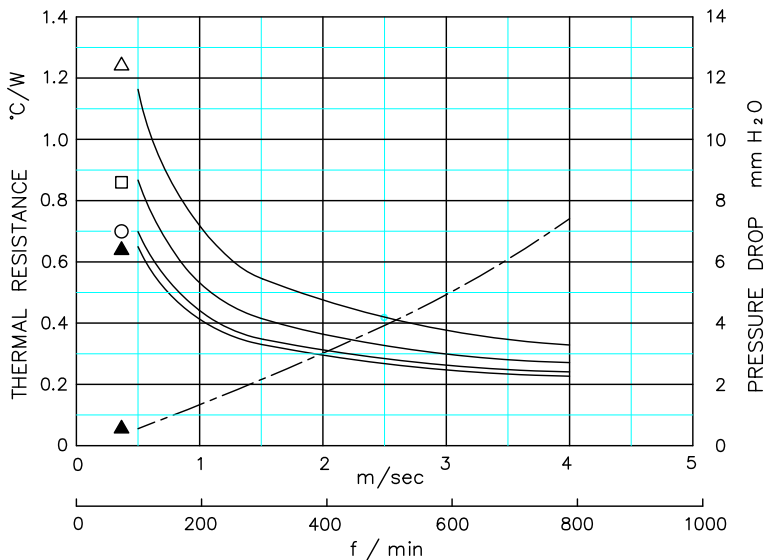

- Δ UB100S-15B
- \square UB100S-20B
- \circ UB100S-25B
- \blacktriangle UB100S-30B

● DUCTED CONDITION
 DUMMY HEATER SIZE: 25 SQ
 THERMAL RESISTANCE ———
 PRESURE DROP - - - - -

■ BASED ON ALPHA'S STANDARD TEST PROCEDURE.
 REFER TO TECHNICAL INFORMATION.

Alpha Company Ltd.

256-1 UEDA, NUMAZU-CITY SHIZUOKA-PREF., JAPAN
 PHONE +81(55)966 0789
 FAX +81(55)966 9192
 E mail : alpha@micforg.co.jp
 URL : <http://www.micforg.co.jp>

Alpha Novatech, Inc. - a subsidiary of Alpha Company.

473 Sapena Ct. #12 Santa Clara, CA 95054 USA
 PHONE +1(408)567-8082
 FAX +1(408)567-8053
 E mail : sales@alphanovatech.com
 URL : <http://www.alphanovatech.com>

REF



● BOARD KEEPOUT PATTERNS

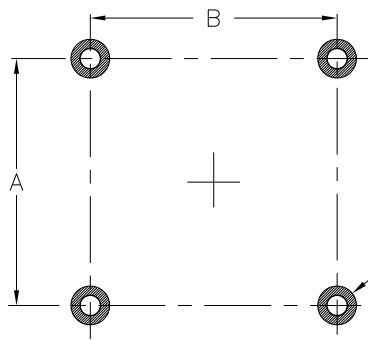

LPD80S AND UB80S	70.0	70.0
LPD90S AND UB90S	80.0	80.0
LPD100S AND UB100S	90.0	90.0
MODEL	A	B

ø8.0 KEEP-OUT AREA
NO COMPONENT PLACEMENT

● INSTALLATION

USE PEM SMTSO-M3-**

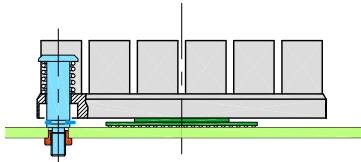

REQUIRES ø4.22 THRU HOLES IN BOARD.
PEM NUTS NEED THE SOLDERING.

USE MAC8 TH-1.6-**-M3

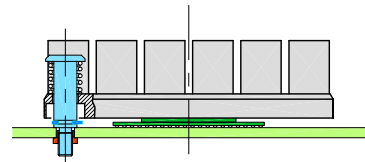

REQUIRES ø3.70 THRU HOLES IN BOARD.
MAC8 THREAD INSERT NEED THE SOLDERING.
RECOMMENDED P.C.B THICKNESS
MIN 1.6mm ~ MAX 3.7mm

USE ALPHA STANDARD BACKING PLATE

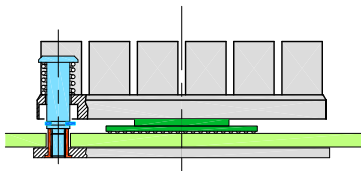

REQUIRES ø4.80 THRU HOLES IN BOARD.

USE HEX NUTS M3x0.5

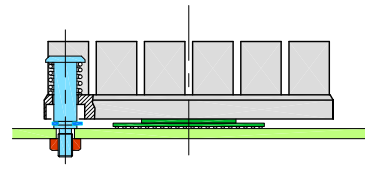

REQUIRES ø3.30 THRU HOLES IN BOARD.

SHOULDER-SCREW / RETAINING RING E-3.0

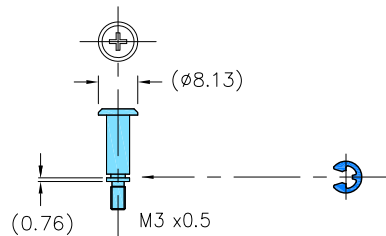

REFER TO THE DRAWING FOR DETAIL SPECIFICATION.